

# GC GROWTIGHT

## INSTALLATION MANUAL

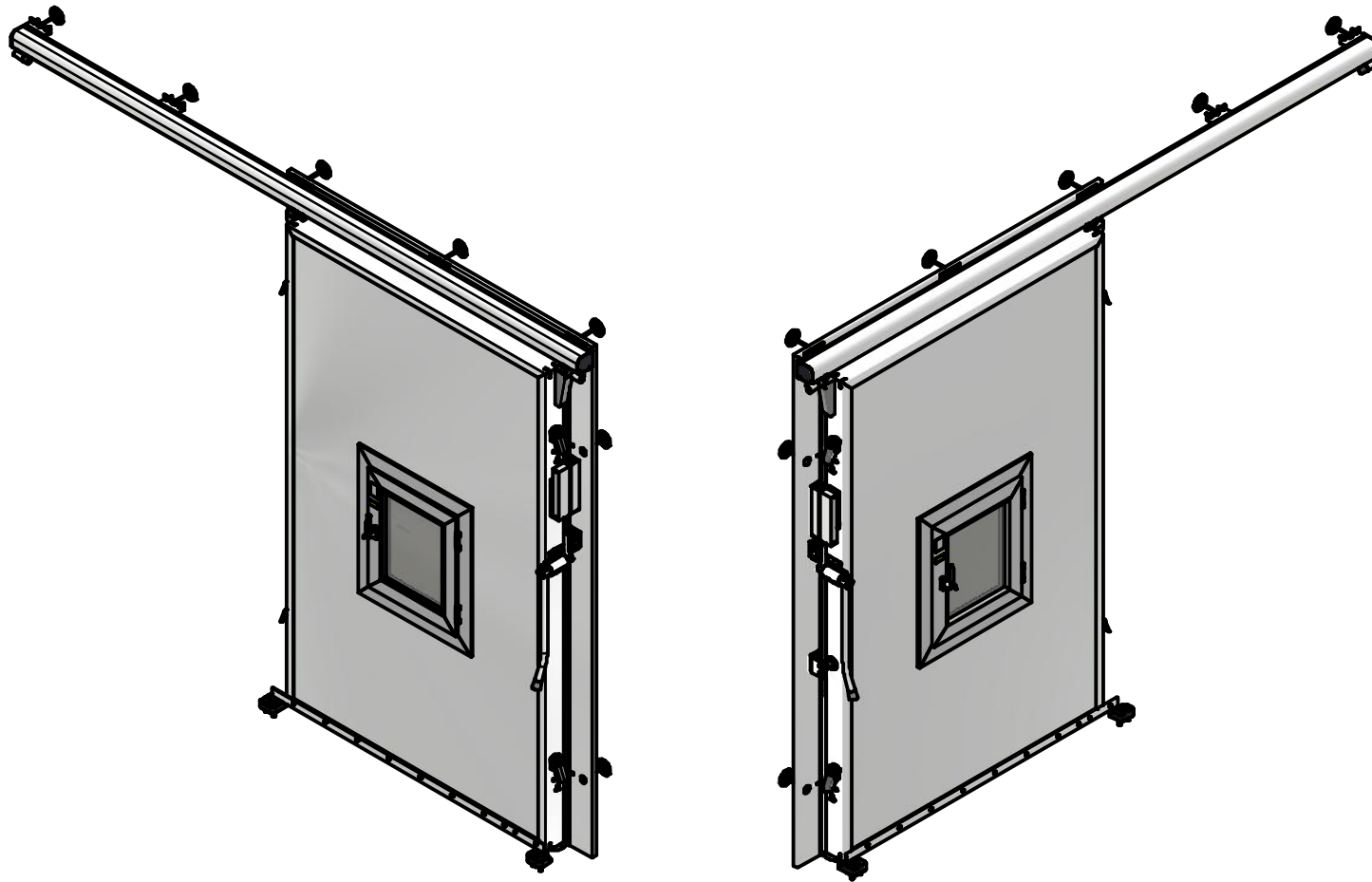

REV 2.3-22



G R O W   C O N T R O L L E D ,   L L C  
100 APPLEWOOD DRIVE SPARTA MICHIGAN - SODUS NEW YORK - UNION GAP WASHINGTON - PADDOCK WOOD UK  
T 616.256.0420 - F 616.887.1128 - INFO@GROWCONTROLLED.COM - GROWCONTROLLED.COM

## ⊥ VERIFY LEVEL WALL

### Areas to Check:

- Wall is Level to the floor
- Levelness across the wall  
(Panel to Panel)
- Level Floor in Door Opening

### If the wall is not level:

- Shims may need to be added  
behind the wall frame
- Floor Grinder in door track area

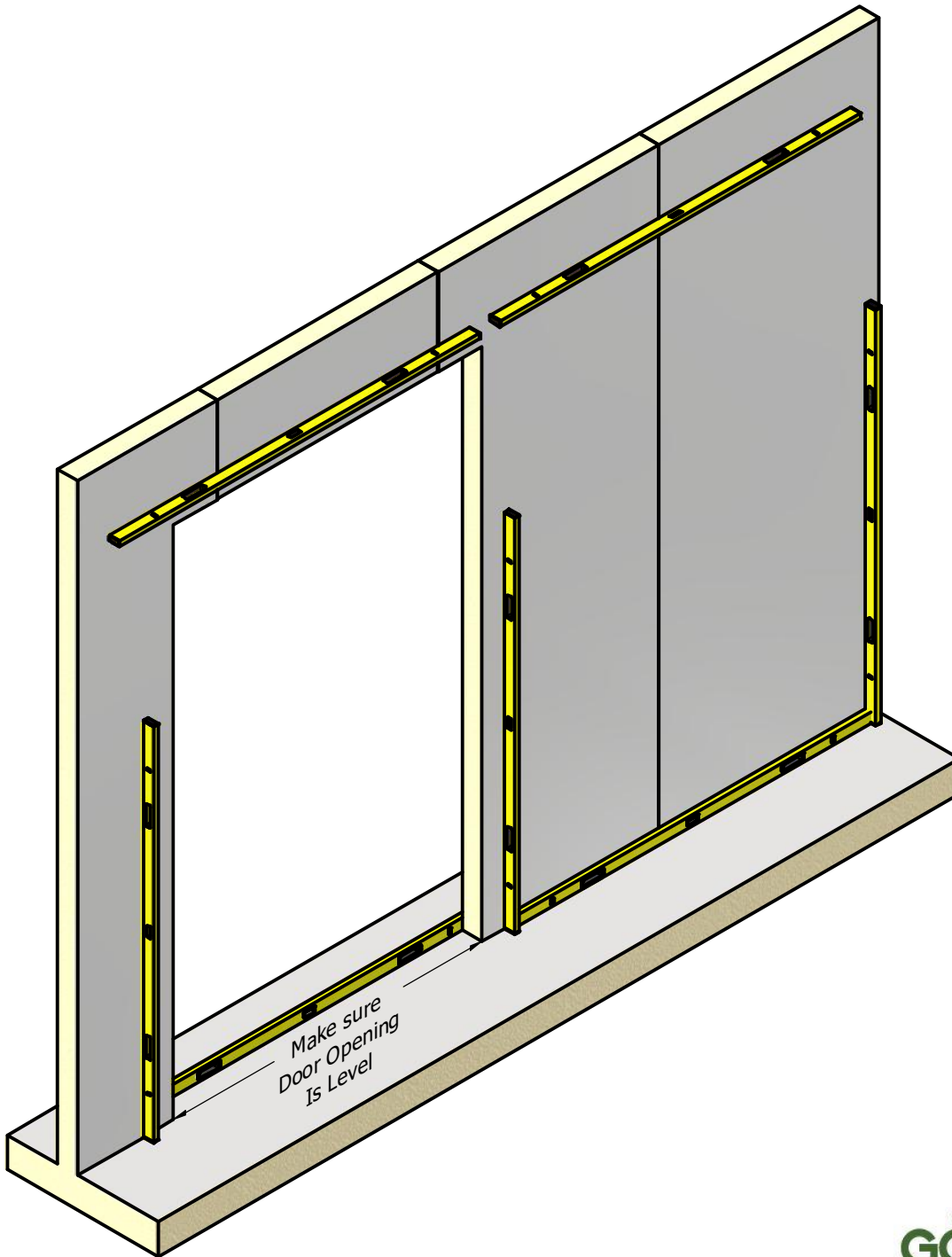

# ASSEMBLING THE WALL FRAME

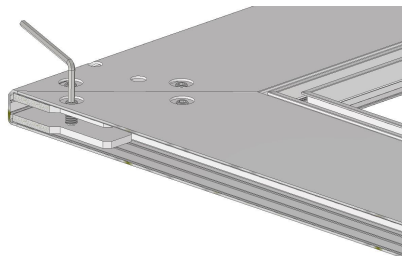
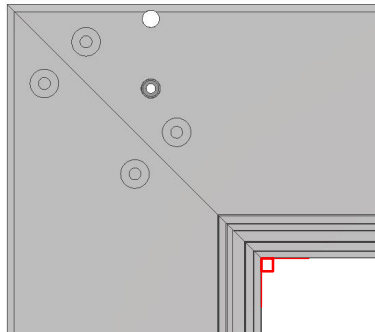
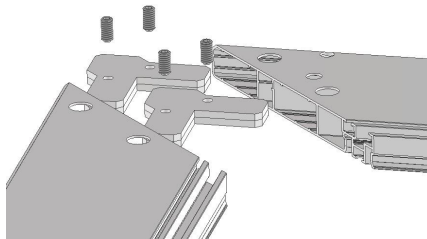
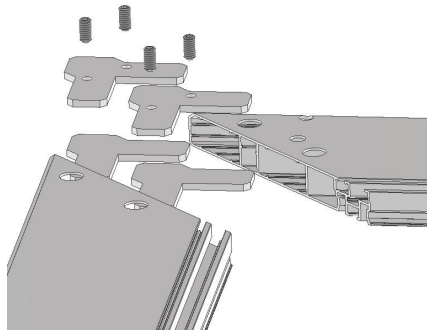

## Wall Frame Top

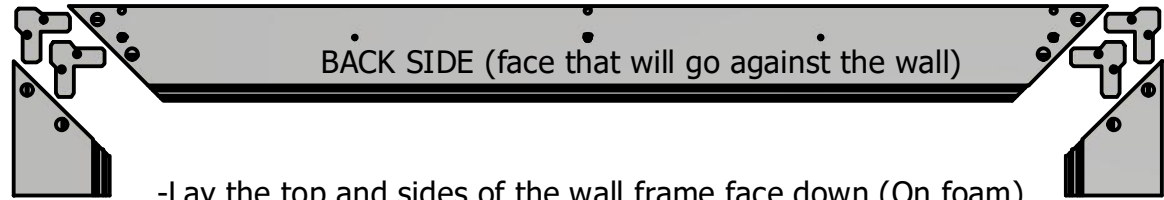

**Right Side Wall Frame**

**Left Side Wall Frame**

-Lay the top and sides of the wall frame face down (On foam)

-Place the Corner Brackets together, blank plate on the bottom

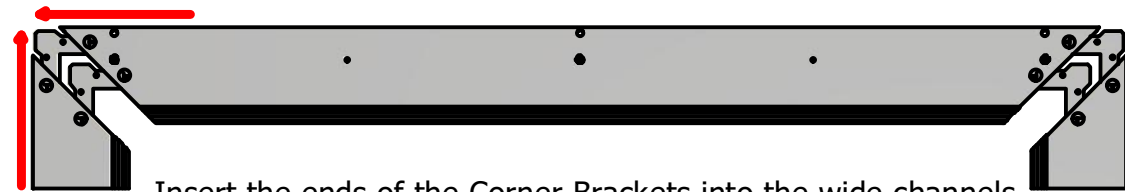

-Insert the ends of the Corner Brackets into the wide channels of the wall frames

-Align the wall frame top and side with corner brackets in place

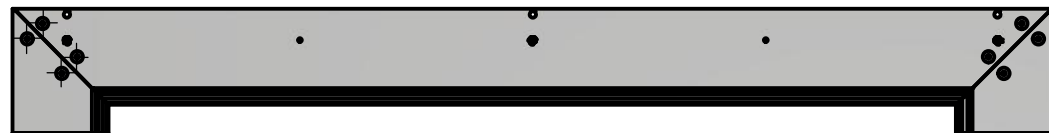

-Center the threaded holes with the holes in the wall frame

-Use an allen wrench to thread in and adjust the set screws & square the wall frame.

-Be sure the grooves of the wall frames are lined up



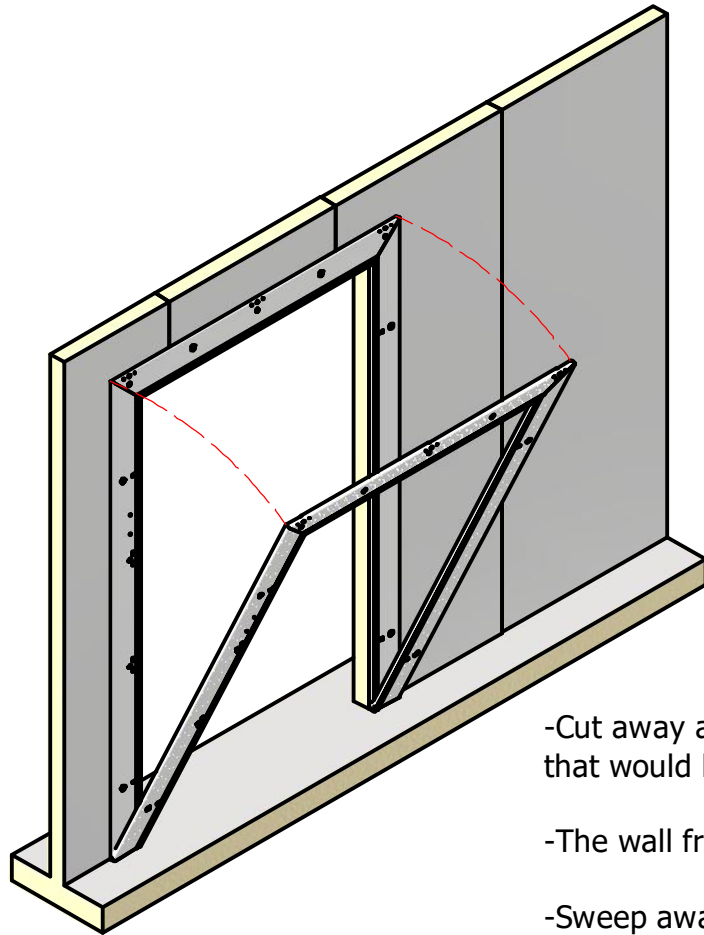

MOUNTING THE WALL FRAME

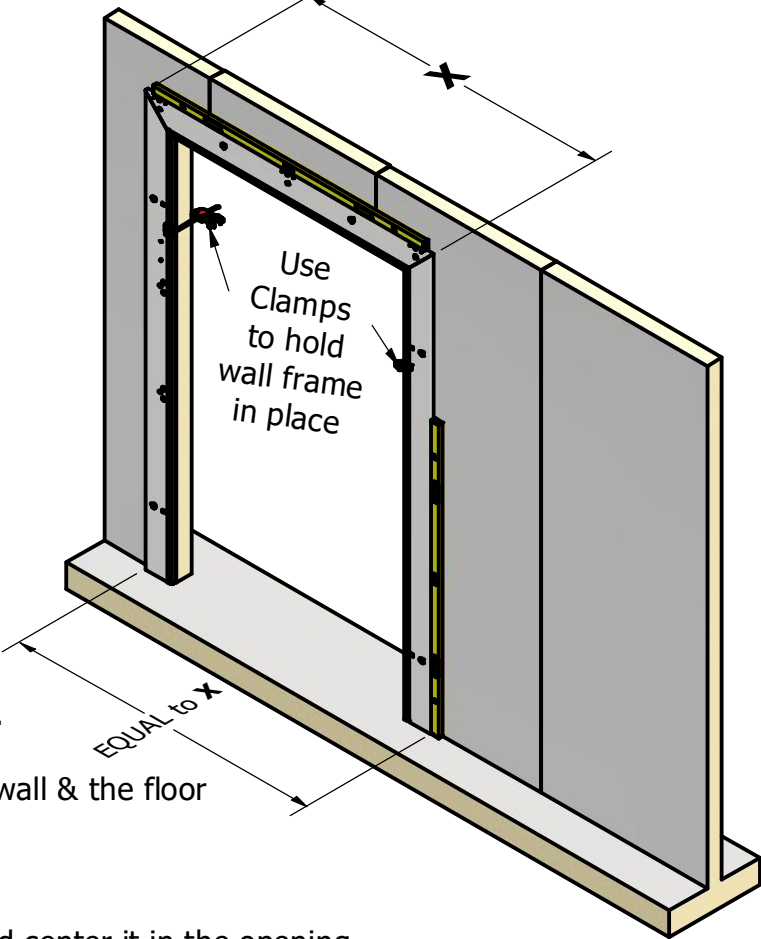

- Cut away any baseboard material or caulk that would be directly behind the wall frame.
- The wall frame should be flush against the wall & the floor
- Sweep away any debris from the doorway
- Stand the wall frame up against the wall and center it in the opening
- Hold the wall frame in place with clamps
- Use a level, if the door frame is not level, shims may be used

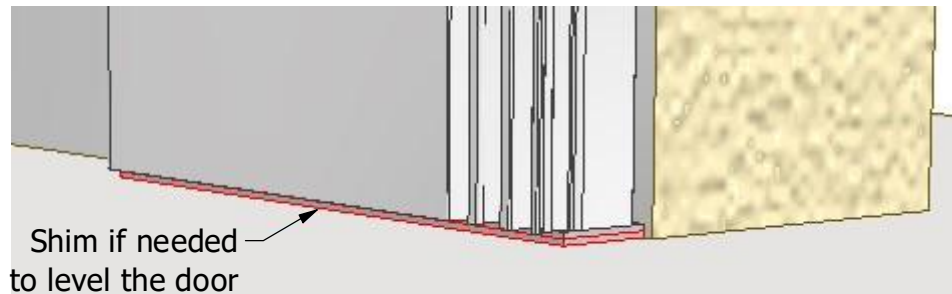

# MOUNTING THE WALL FRAME

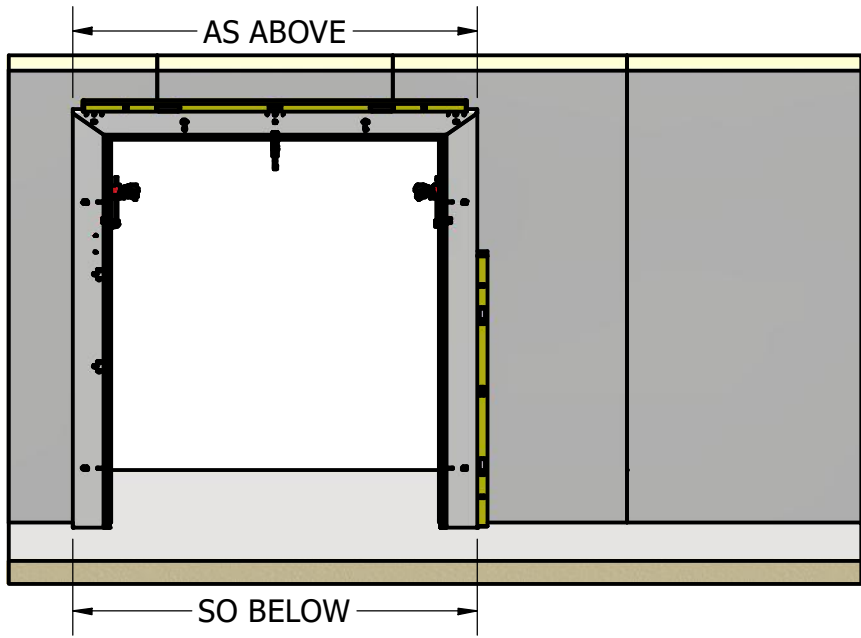

- Make note of the measurement from corner to corner of the top of the wall frame
- Check Level
- The measurement at the floor of the wall frame should be the same as the top
- Check level, shim the bottom, if needed

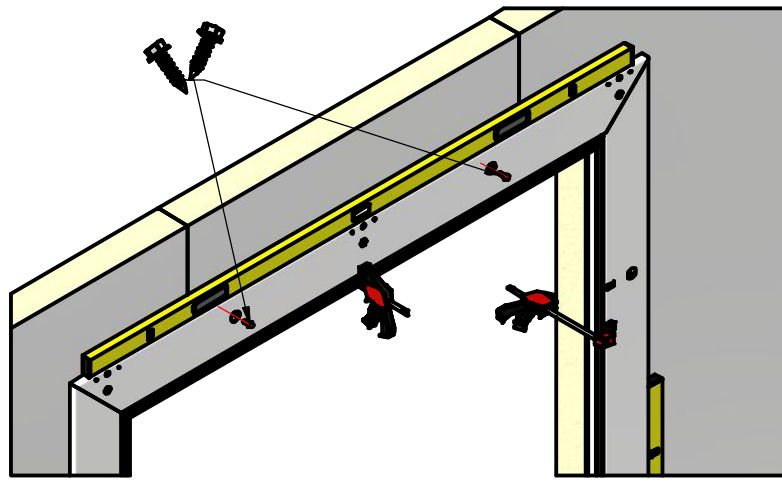
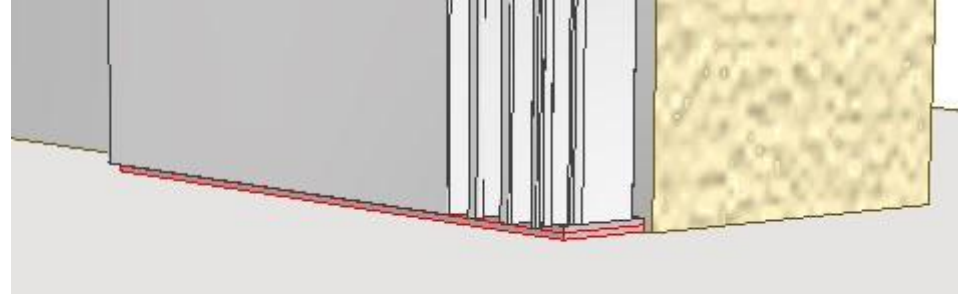

-Once level, fasten the top wall frame to the wall with (2) sheet metal screws + washers

# MOUNTING THE WALL FRAME

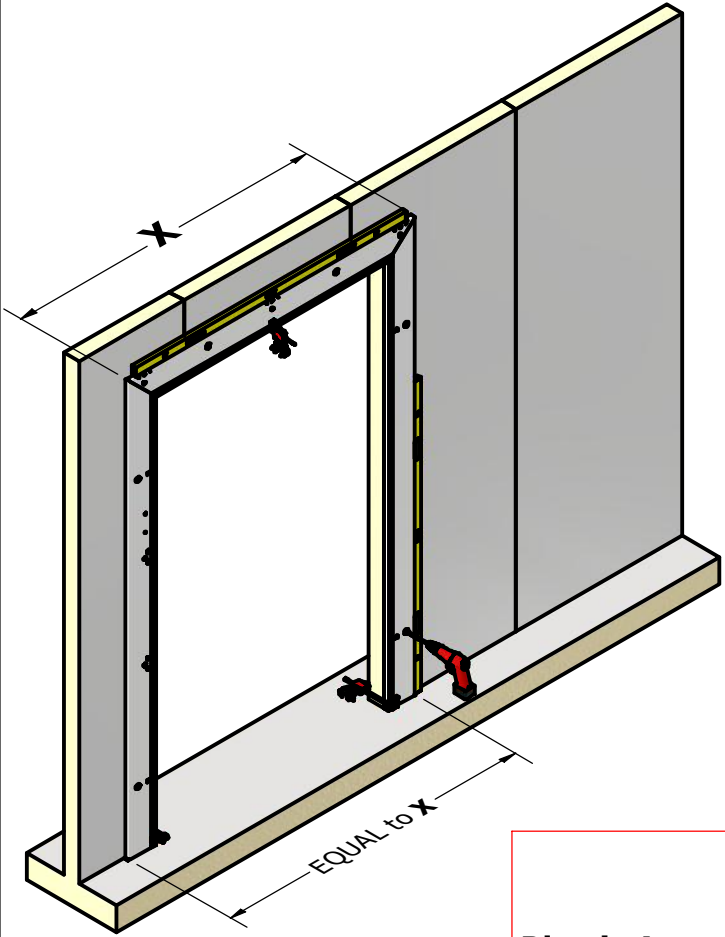

-Use a  $\varnothing 16''$  extended length drill bit to drill all the way through the lower hole

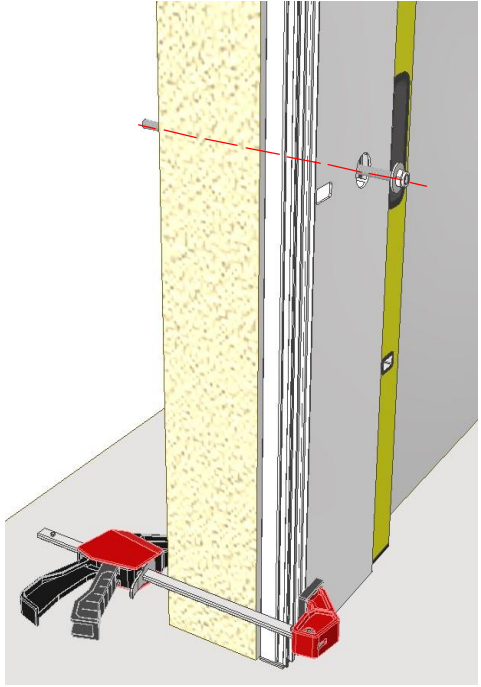

-After the hole is drilled, assemble the **M8 Lock Washer** & **M8 Lock Nut** to one end of the **Threaded Rod**

-Insert the sub-assembly through the lower hole

Note: Make sure the marked side of the washer is facing the frame

## Set of Threaded Rods

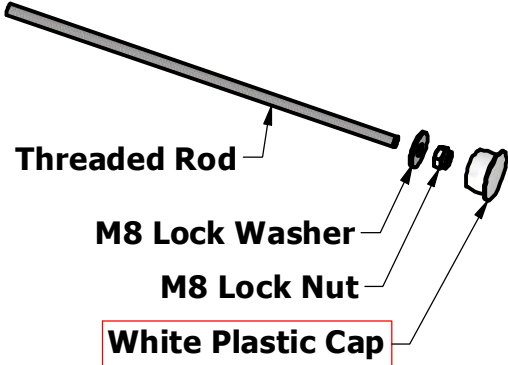

-Check the level at the top and the measurement from corner to corner

-Check level and measurement at the bottom

-Once equal & level, clamp the bottom of the wall frame

Do not fully assemble before reading ahead

# MOUNTING THE WALL FRAME

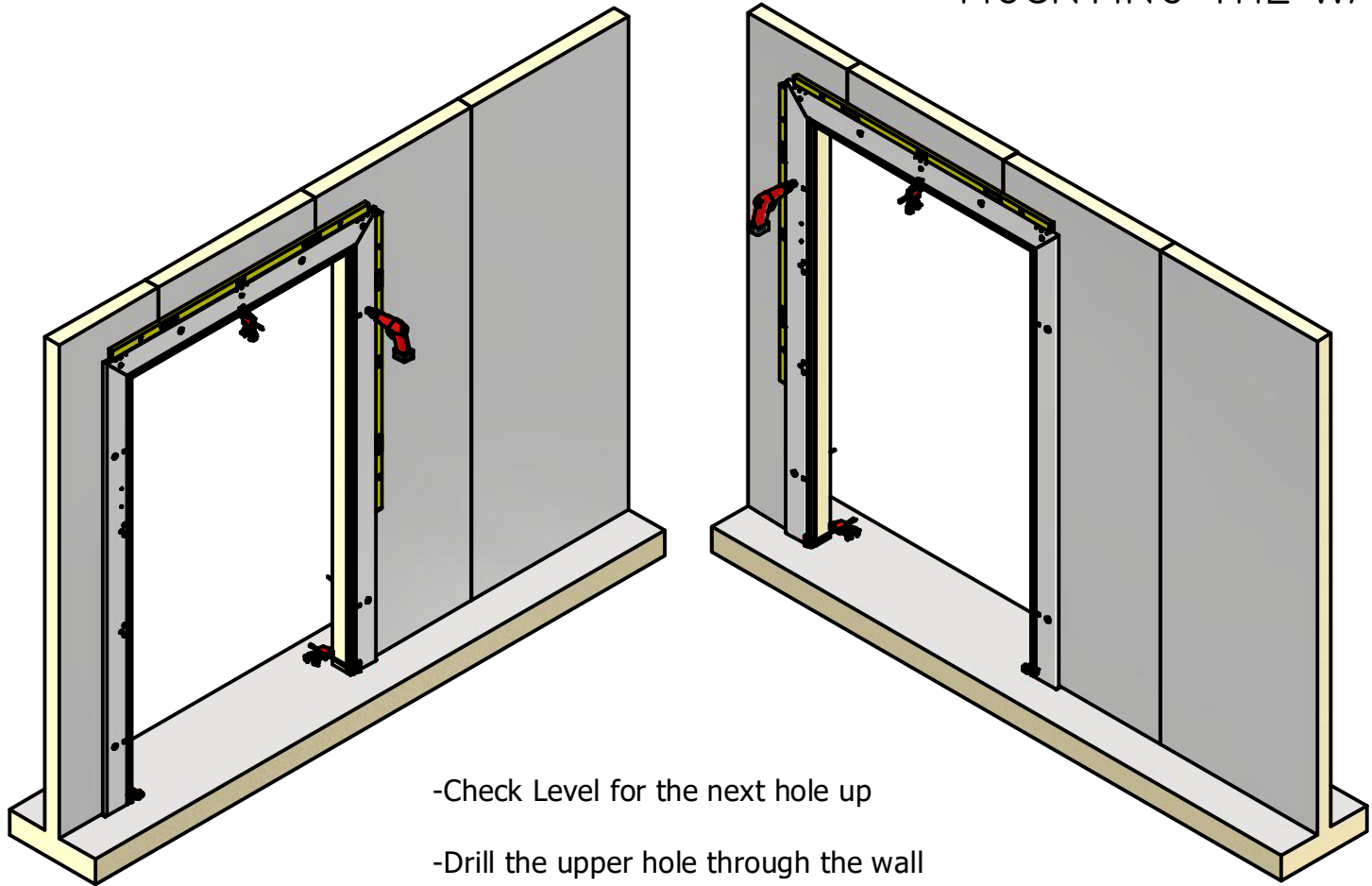

- Check Level for the next hole up
- Drill the upper hole through the wall
- Insert a threaded rod sub-assembly
- AFTER** both holes for right side are finished, **Repeat** the same process for the (2) holes on the left side
- Be sure the door is square



# MOUNTING THE WALL FRAME

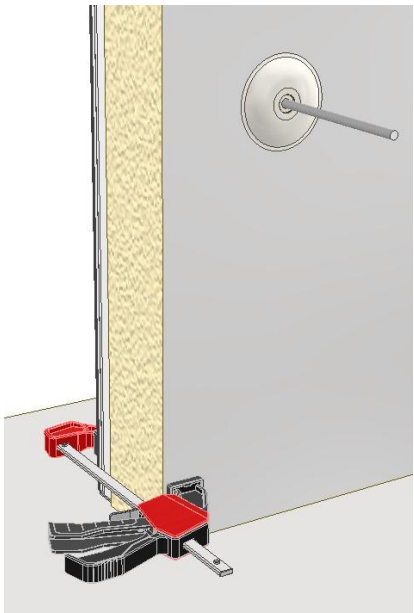
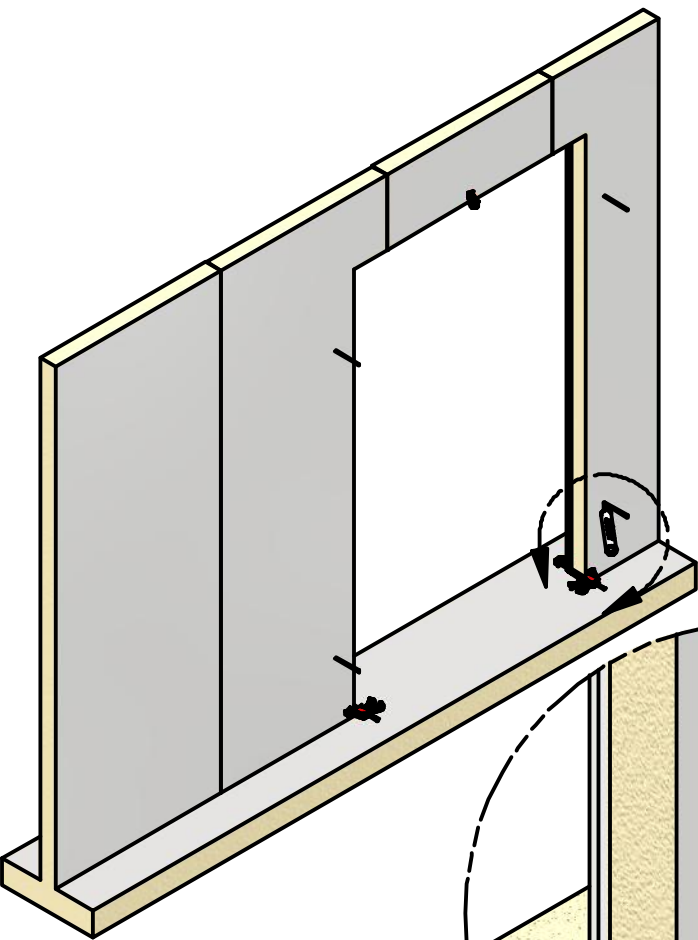

- Slide the **Finishing Disc** over the threaded rod
- Slide the **Plain Washer** & screw on the **Hex Nut**
- Snug the hex nut but do not tighten yet, to allow for final frame adjustment
- Repeat for all (4) threaded rods

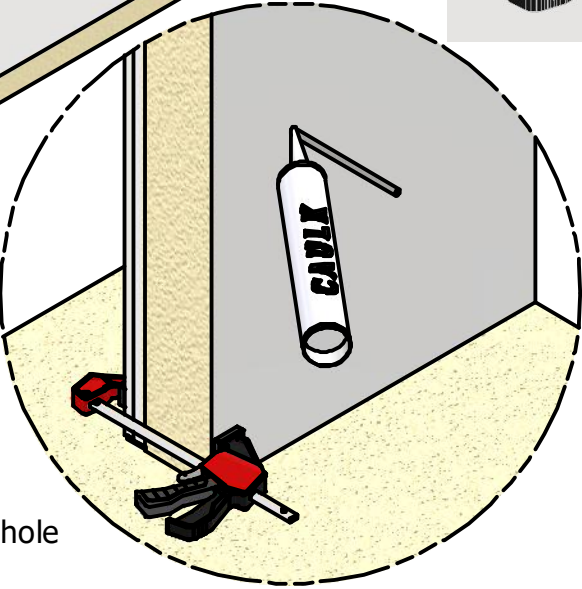

- On the inside of the room, brush away any dust/debris from drilling the holes
- Clean the area around the hole with alcohol
- Caulk the hole** around the rod white NP1 or 798

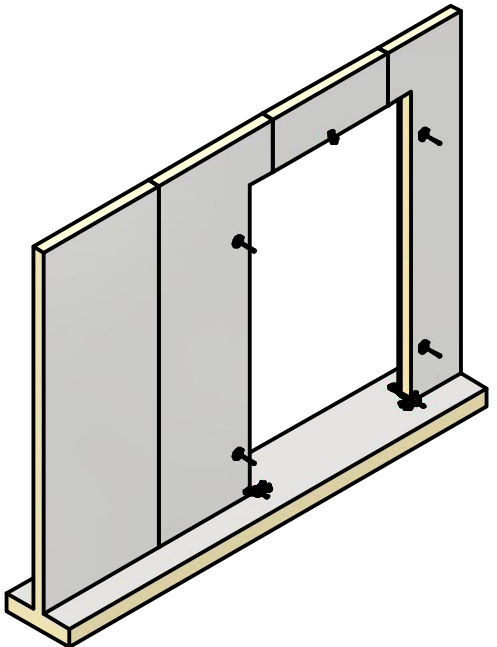



# MOUNTING THE WALL FRAME



-Check the Level on the face of the wall frame for perpendicularity

-If the wall is not perpendicular to the floor, **shims** may be inserted **behind the wall frame**

-Adjust clamps as needed

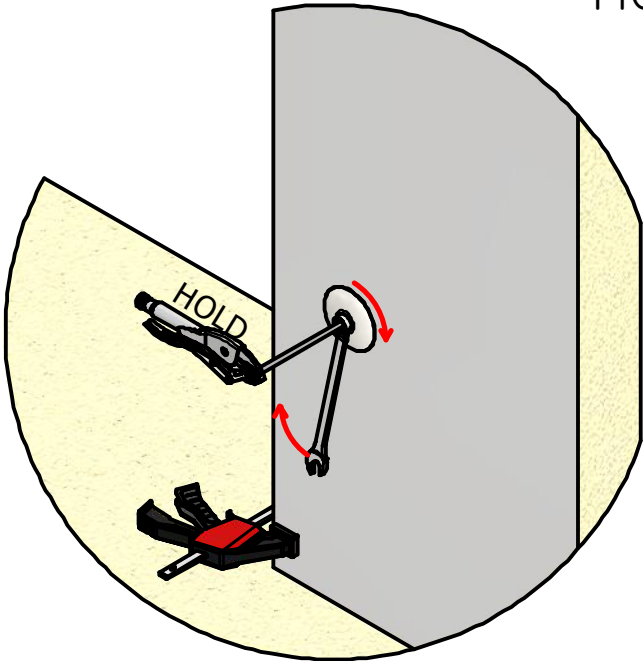

-Once the wall frame is level, tighten the hex nuts to hold the wall frame in place (**13mm**)

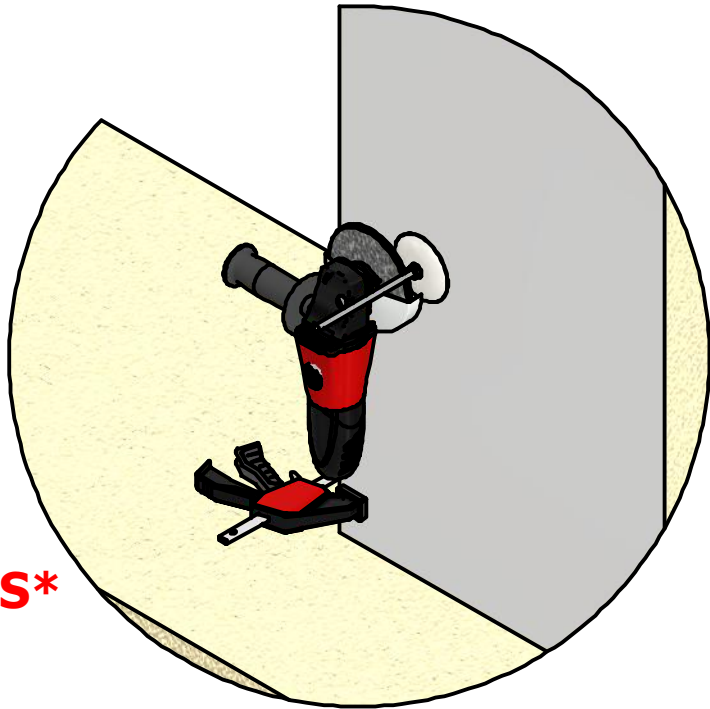

-Once the caulk is dry  
Use an angle grinder  
to grind off the threaded rod  
leaving it just above nut

**\*WEAR SAFETY GLASSES\***

# MOUNTING THE WALL FRAME

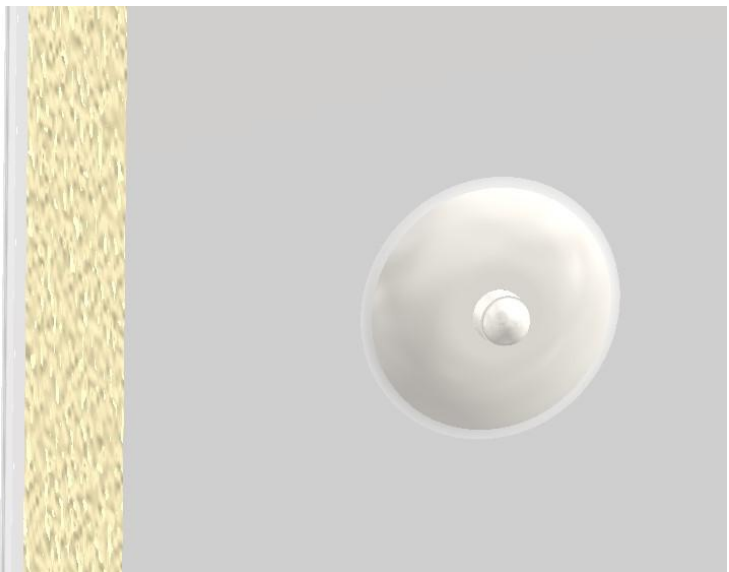

-Apply "just a touch" of 798 or NP1 to the inside of the **Plastic Acorn Nuts**  
-Position the acorn nuts on the cut ends of threaded rod  
Tap into place with a mallet

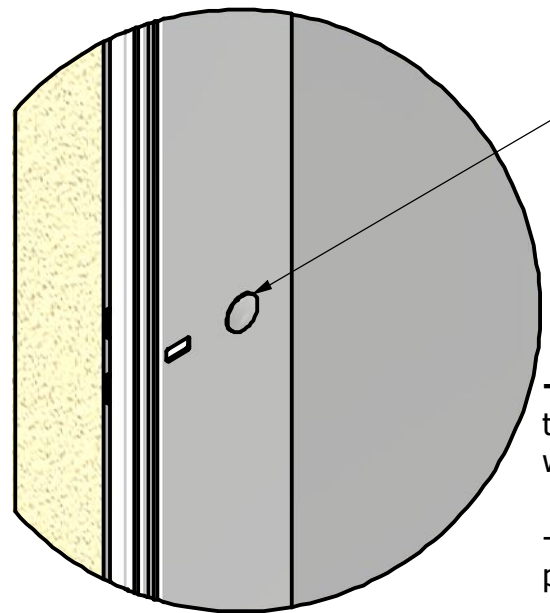
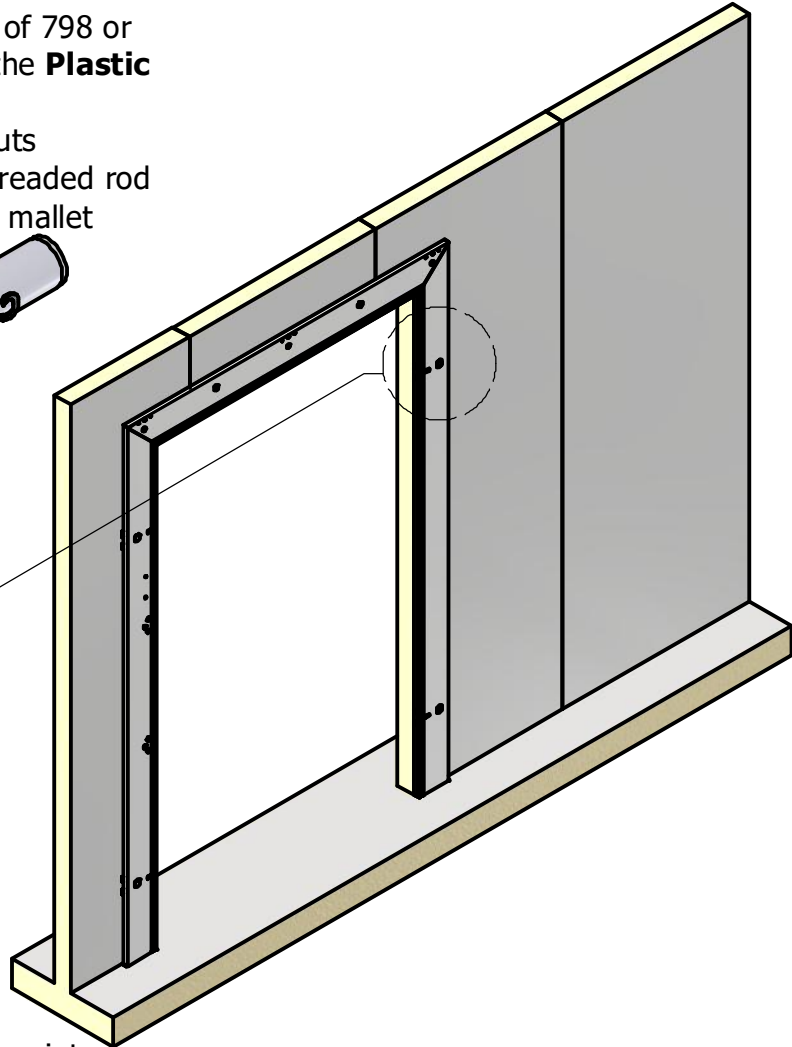
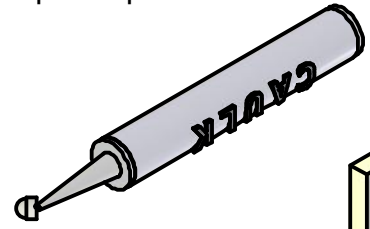

-Insert **Plastic white caps** into the (4) holes on the face of the wall frame  
  
-Use a mallet to get the caps flush, peel away shaved plastic ring

# DOOR TRACK ASSEMBLY

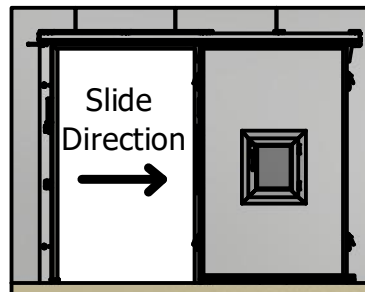
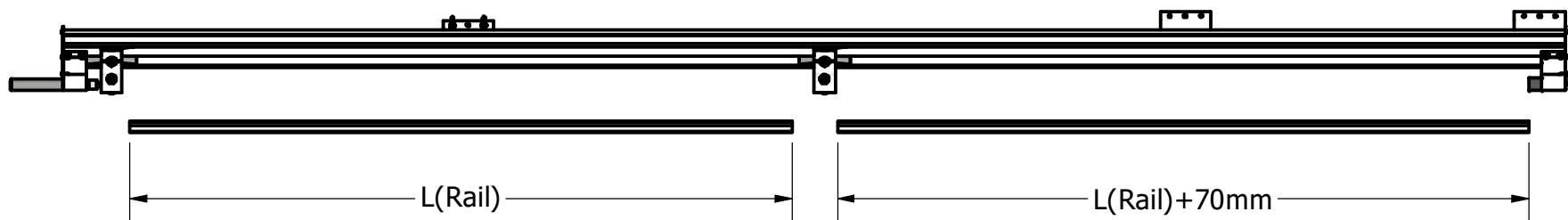
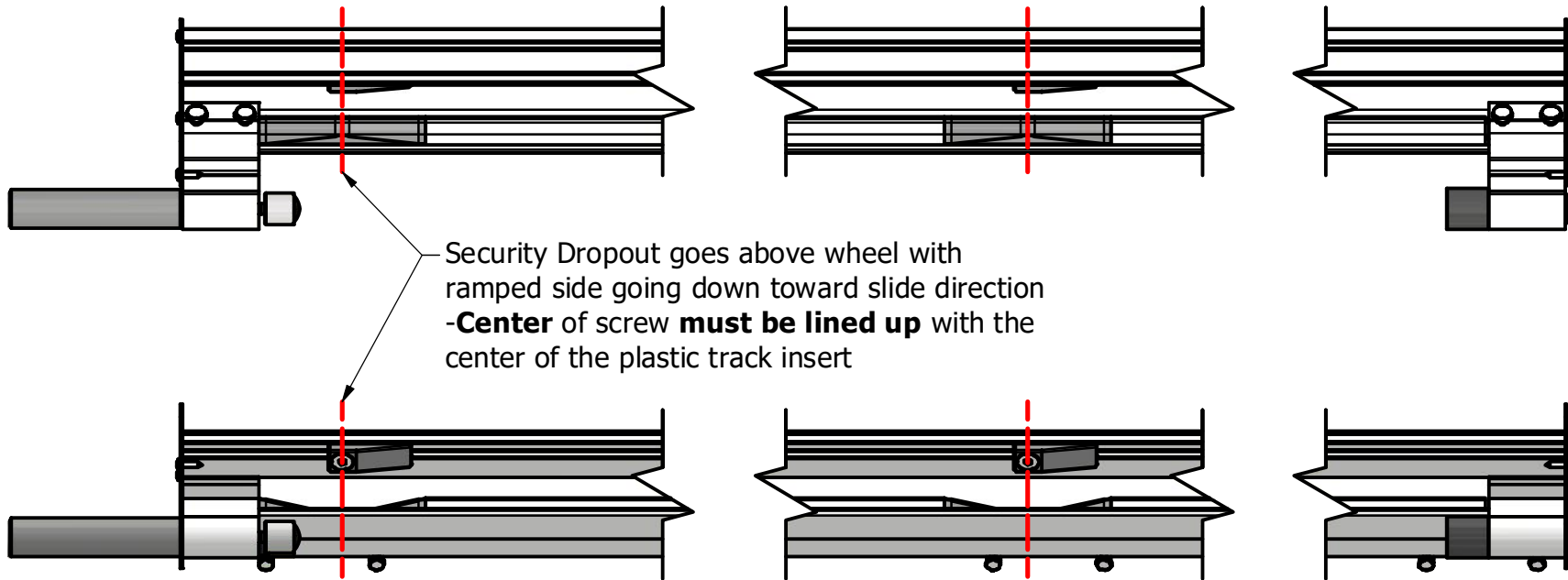

The longer rail will slide in on the OPEN POSITION side of the door track

Example shown: Right Slide

# DOOR TRACK ASSEMBLY

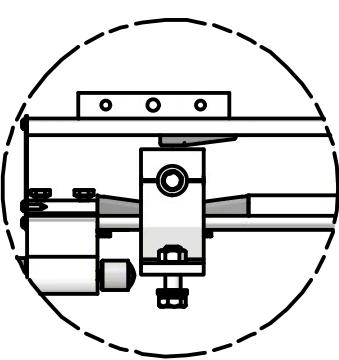
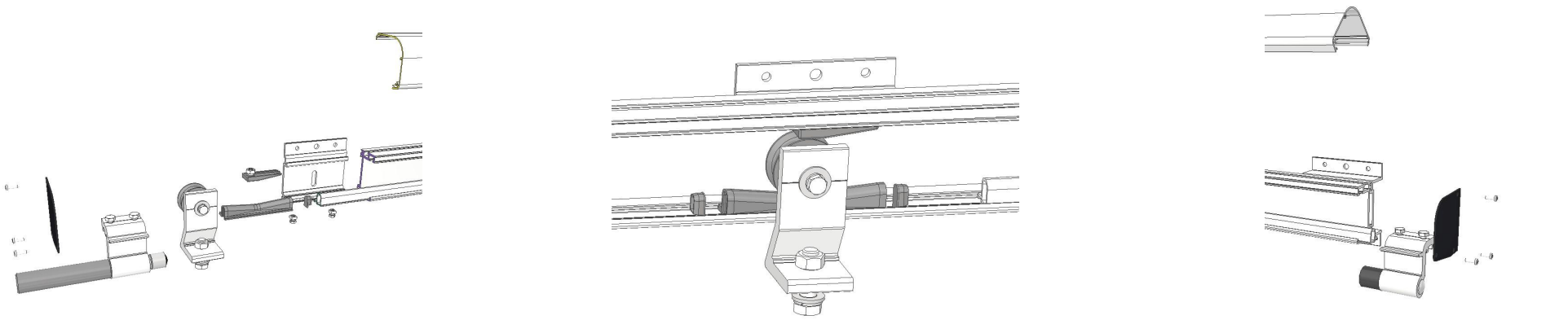
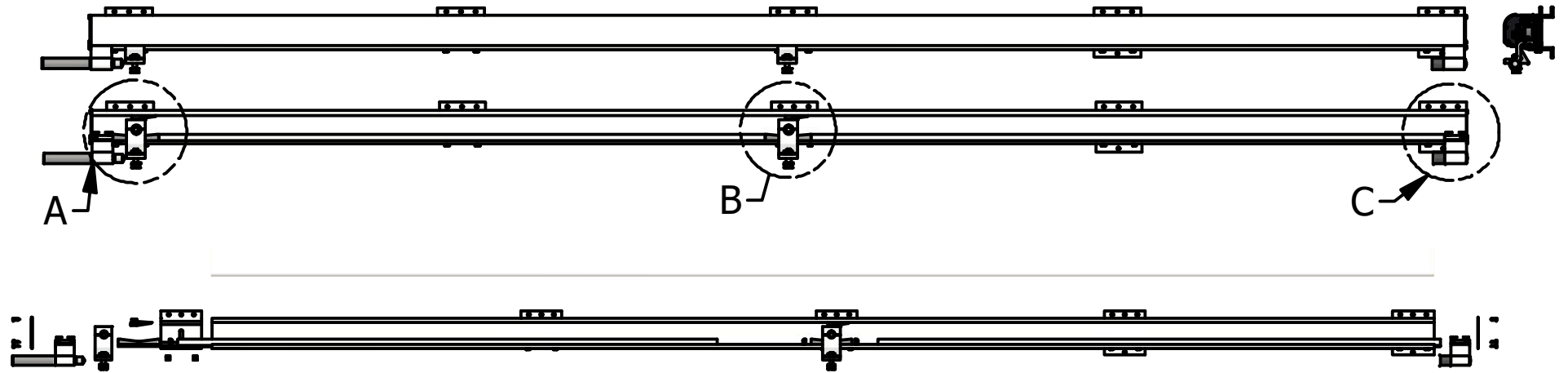

Detail A

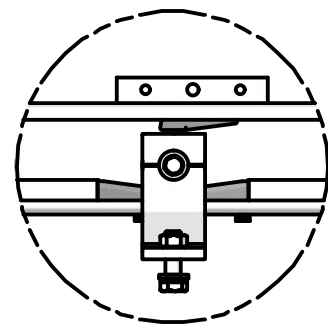

Detail B

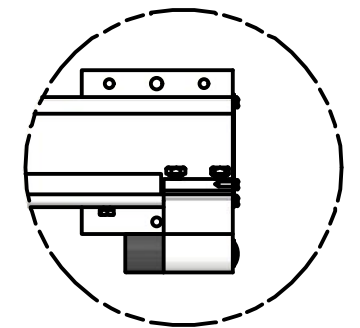

Detail C

Example shown: Right Slide Track



GROW CONTROLLED, LLC  
100 APPLEWOOD DRIVE SPARTA MICHIGAN - SODUS NEW YORK - UNION GAP WASHINGTON - PADDOCK WOOD UK  
T 616.256.0420 - F 616.887.1128 - INFO@GROWCONTROLLED.COM - GROWCONTROLLED.COM

# WALL FRAME BRACKETS

## Each (3) **Wall Frame Bracket:**

- Ø8mm X 1.25 thread, 25mmL Bolt + Spring Washer hold the bracket in place by using the **slotted hole** and threaded into the **rivnut** in the wall frame

-Then **fasten** the bracket with two sheet metal screws through the **upper corner holes** in the bracket

-Through the **center hole**, **Drill** a hole through the wall, using a  $\frac{5}{16}$ " Extended Length drill

-**Last**, Insert the sub-assembly of a threaded rod, washer & M8 Lock Nut through the drilled hole

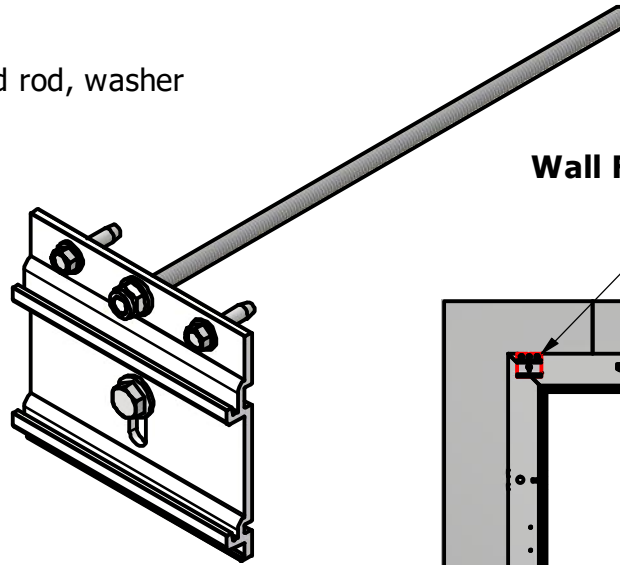
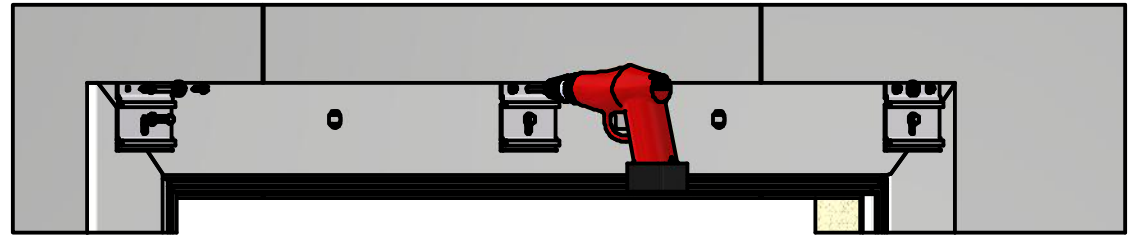

Wall Frame Brackets

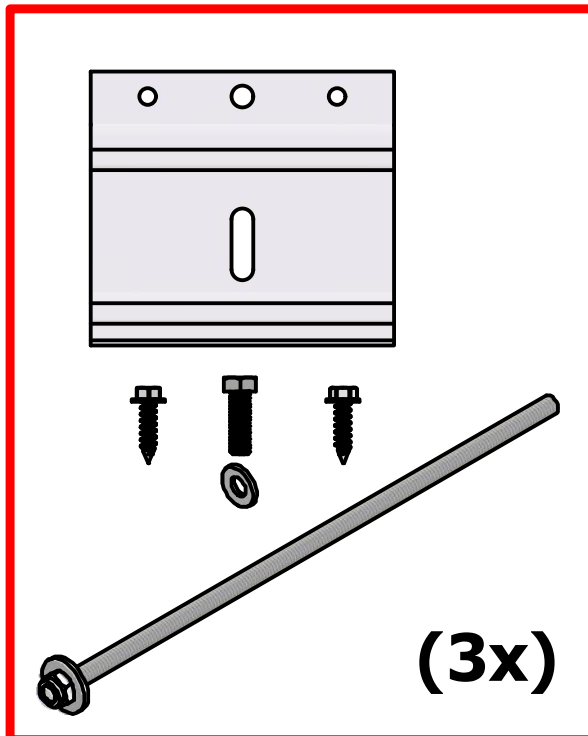
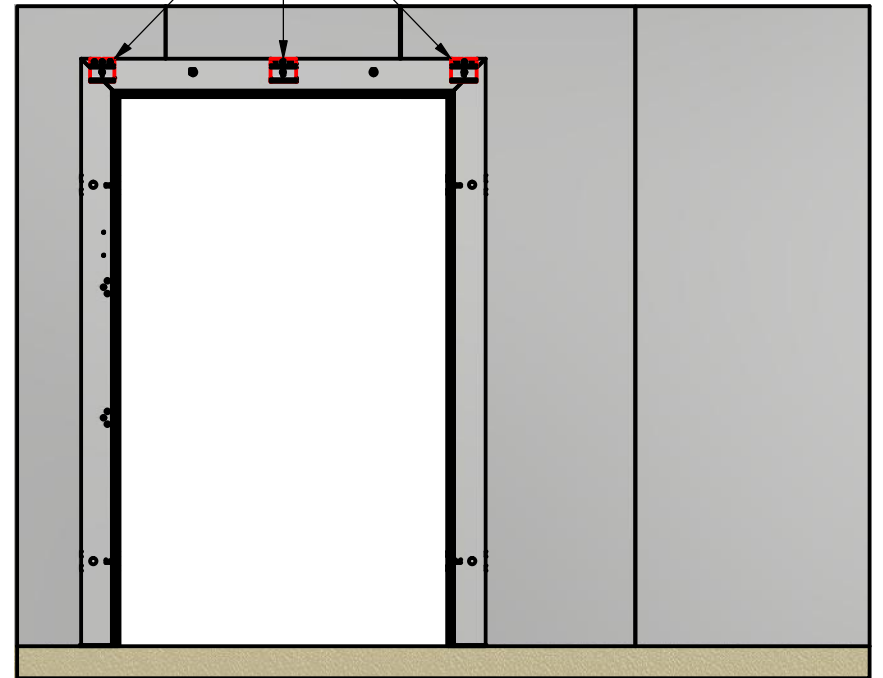

# WALL BRACKETS

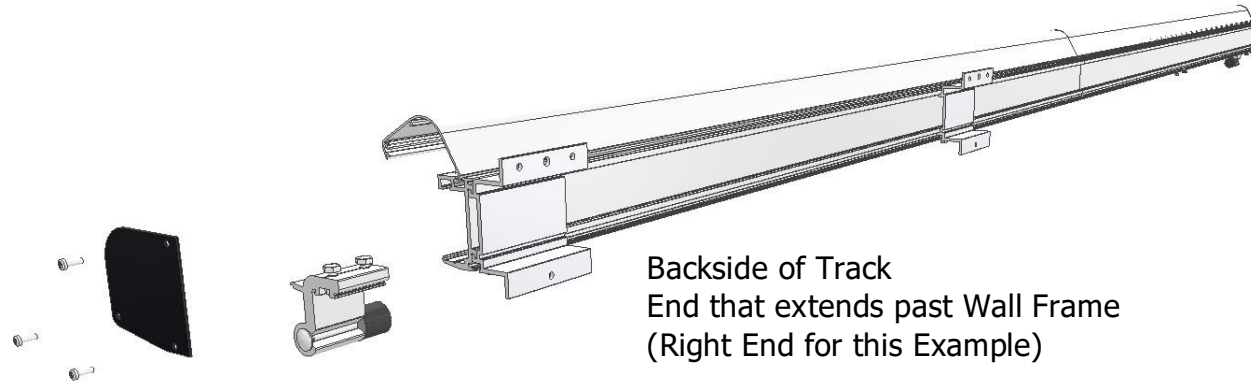

Backside of Track  
End that extends past Wall Frame  
(Right End for this Example)

-Wall Bracket sub assemblies slide into the channel on the back of the track.

-(1) Wall Bracket will be at the end and the other will be a centered distance from the wall frame bracket

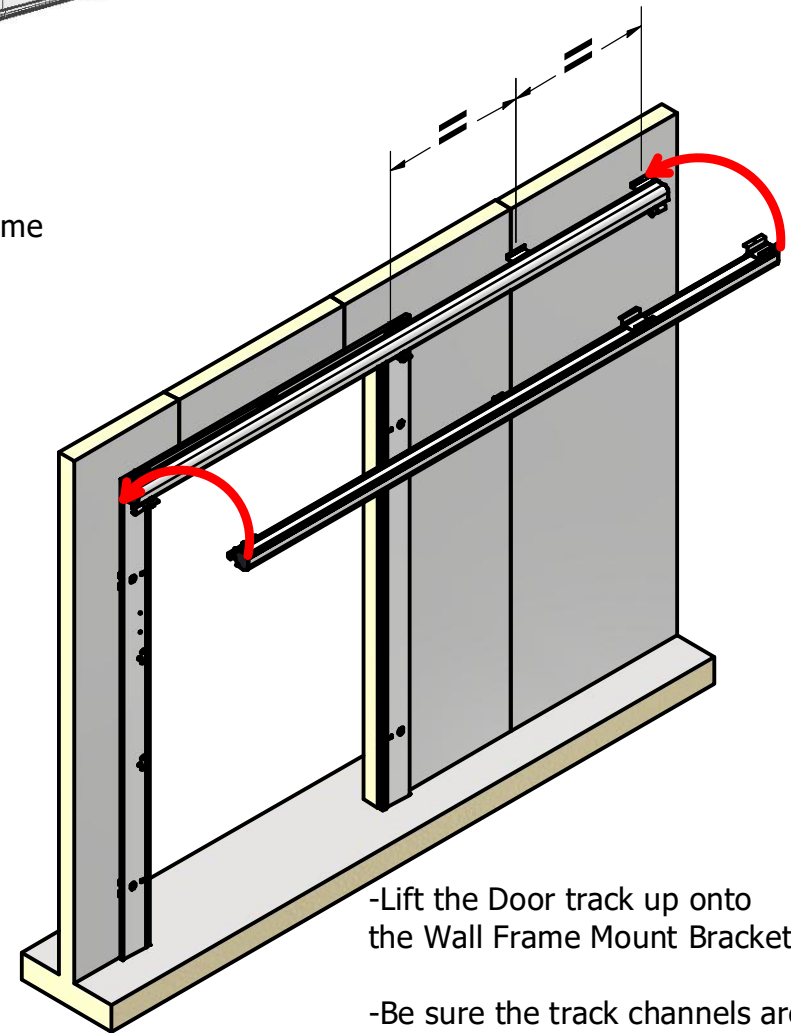

-Lift the Door track up onto the Wall Frame Mount Brackets

-Be sure the track channels are properly set into the slots across all three wall frame brackets.

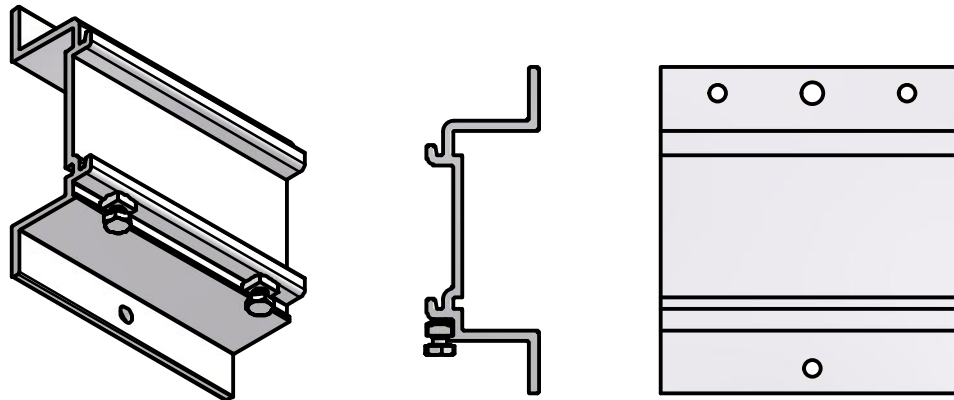

**Wall Bracket**

+

**(2) 6mm hex head bolt**

+

**(2) Square Nut**



**X 2**

-(2) 6mm Hex head screws with Square nuts slide into the lower channel side of each wall bracket, as shown



GROW CONTROLLED, LLC  
100 APPLEWOOD DRIVE SPARTA MICHIGAN - SODUS NEW YORK - UNION GAP WASHINGTON - PADDOCK WOOD UK  
T 616.256.0420 - F 616.887.1128 - INFO@GROWCONTROLLED.COM - GROWCONTROLLED.COM



# WALL BRACKETS/MOUNTING THE DOOR TRACK

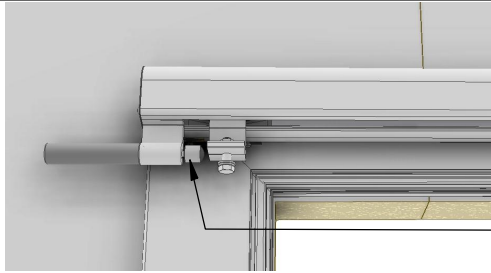

If Soft Closer is included, use it on the **closing side** of the track (Maglock Side)

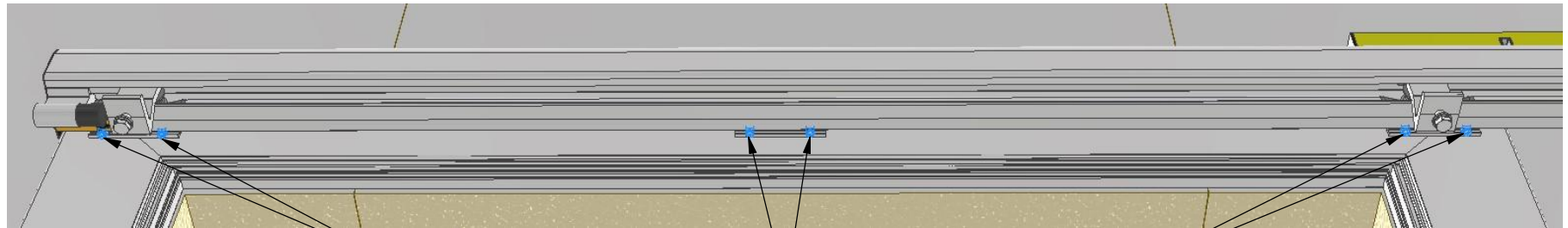

Secure the door track by assembling hex head screws & Square Nuts into the channels of the wall frame brackets

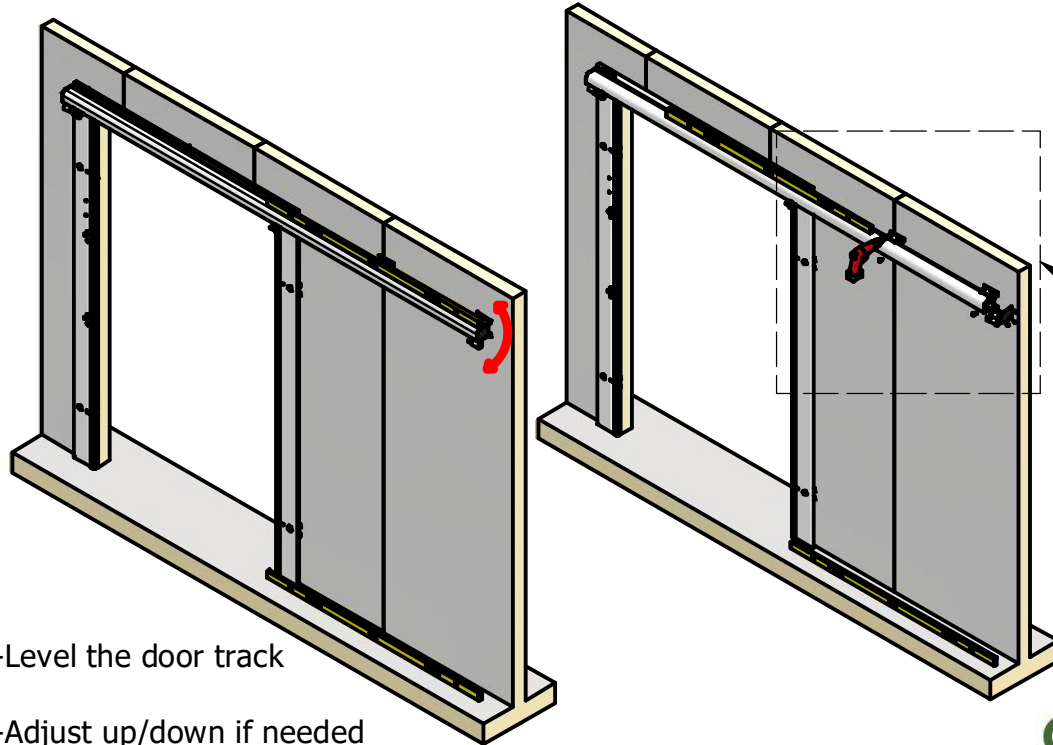

-Level the door track

-Adjust up/down if needed



X 2

-Once level, mark the position of the wall mount brackets

-Drill a pilot hole & fasten the wall brackets with (3) sheet metal screws each

Note: Track may need to be removed back off the wall to fasten wall brackets, depending on socket length, then put back on  
**NO PERMANENT MARKERS**

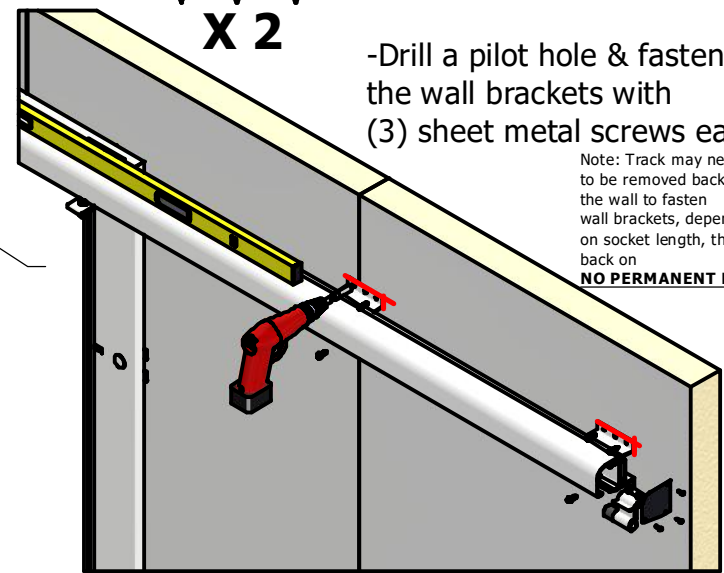

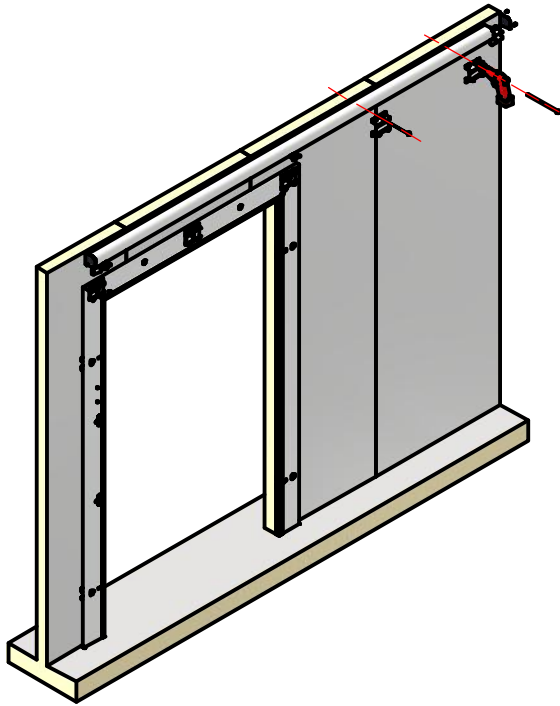

-Drill  $\frac{5}{16}$ " center hole of the wall brackets through the wall for the threaded rod sub-assembly

Note: The Door Track may need to be lifted from the wall brackets to be able to drill the holes.

-After the Door Track is mounted, go through the process of sealing & capping the threaded rods on the inside of the room:

-Wipe down the area with alcohol

-Caulk the hole around the threaded rod with NP1 or 798

-Tighten Hex Nut & Washer

-Allow to Dry

-Grind off threaded rod to the nut

-Cap with Plastic Acorn Nut

## MOUNTING THE DOOR TRACK

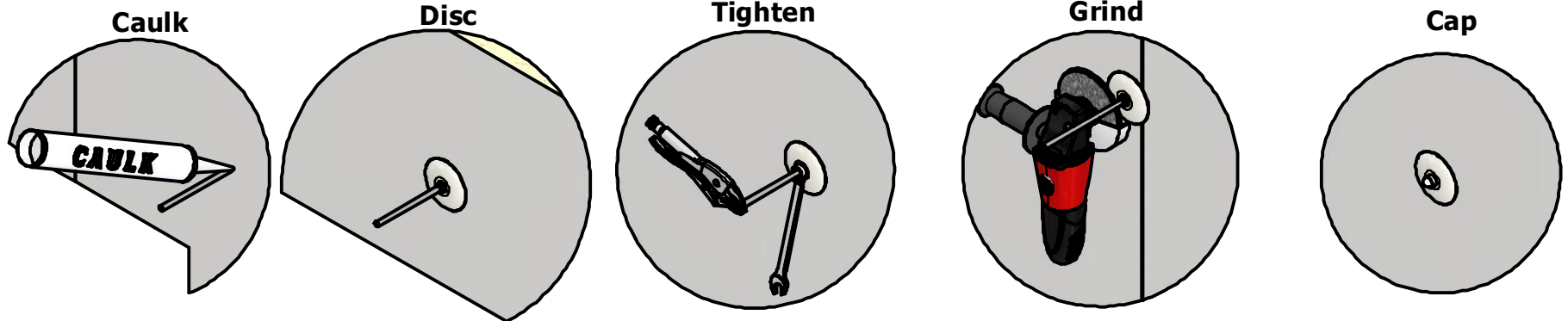
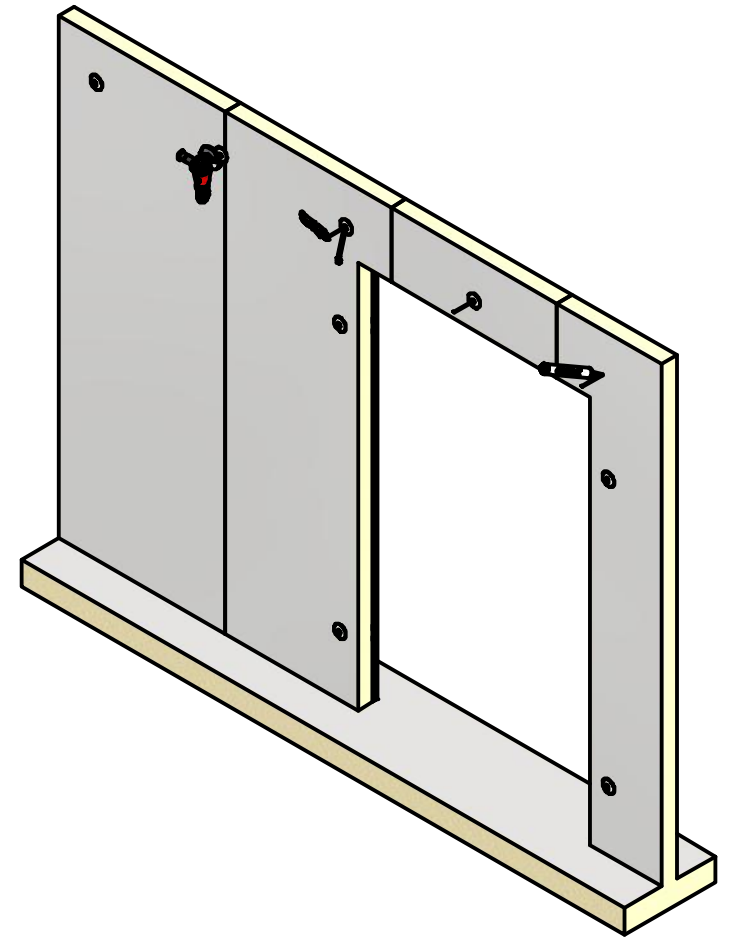

# BLACK THERMAL BREAK

Use a dead blow mallet to insert the **Black Thermal Break** into position

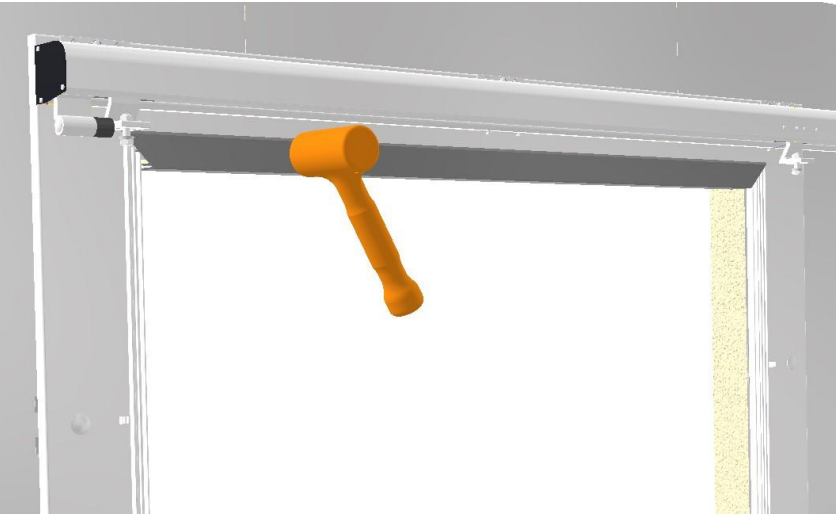

- Do the **top** trim piece **first**, then the sides
- For the L/R sides: start with the top corner (caulked), then insert the lower end

- Tap into place from the bottom-up  
This prevents the trim from twisting & warping as you tap it into place
- Doing this also keeps the corner in tact, as the thermal break may shift when struck

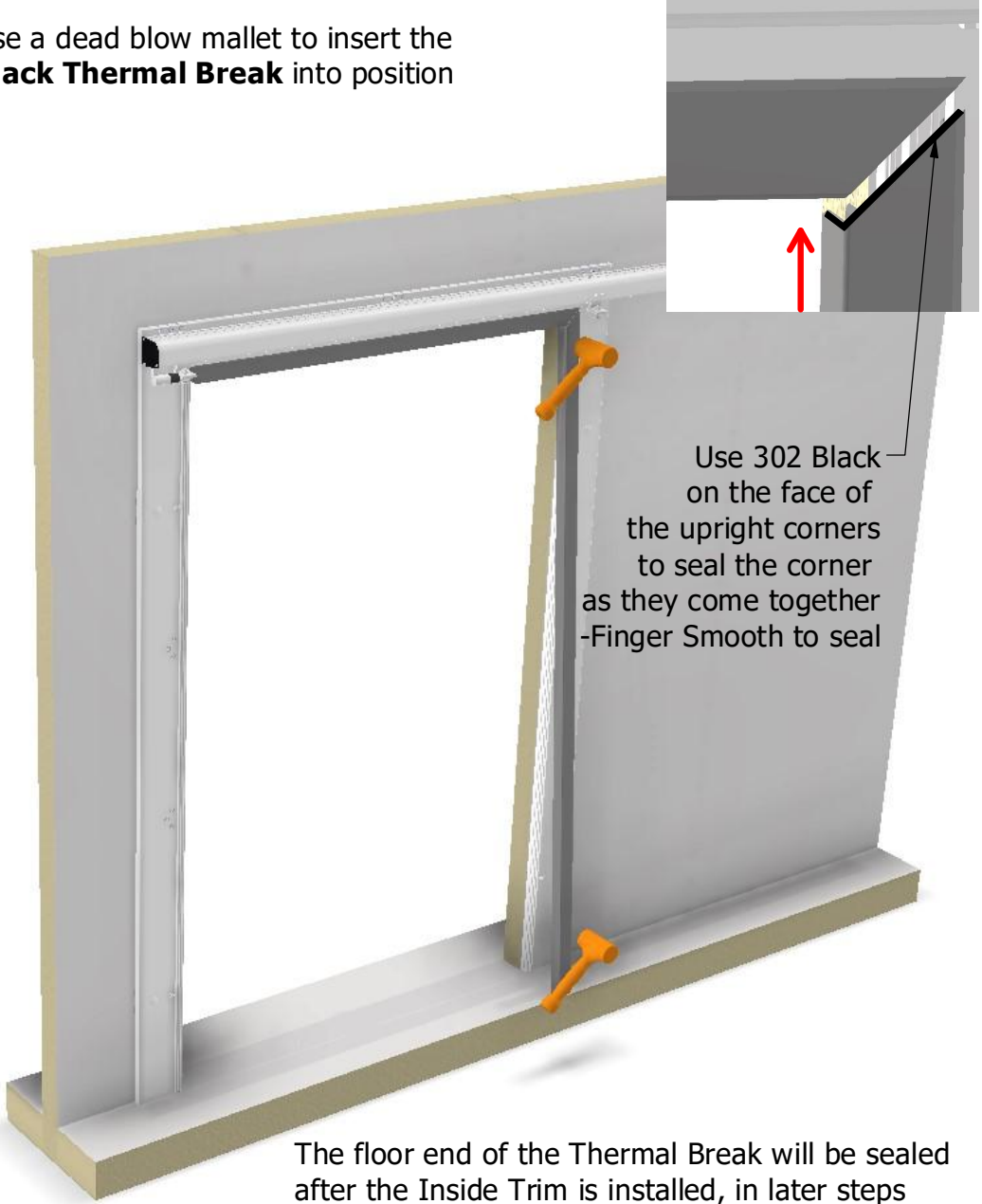
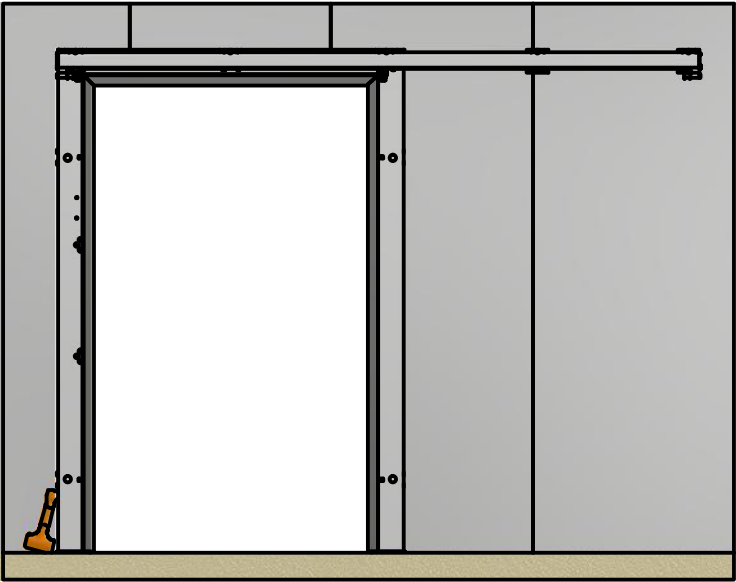

Use 302 Black on the face of the upright corners to seal the corner as they come together  
-Finger Smooth to seal

The floor end of the Thermal Break will be sealed after the Inside Trim is installed, in later steps

# FLOOR RADIUS

-Apply a layer of Black 302 caulk to the back & bottom of the Radius before installing in place

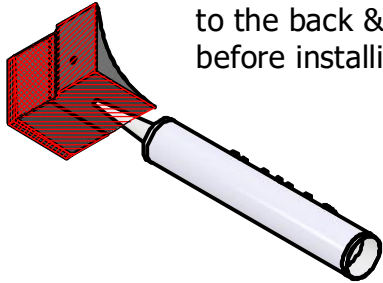

## **\*Important\***

This area must be well sealed to prevent leaks at the floor



-Fasten the Radii with the screws provided

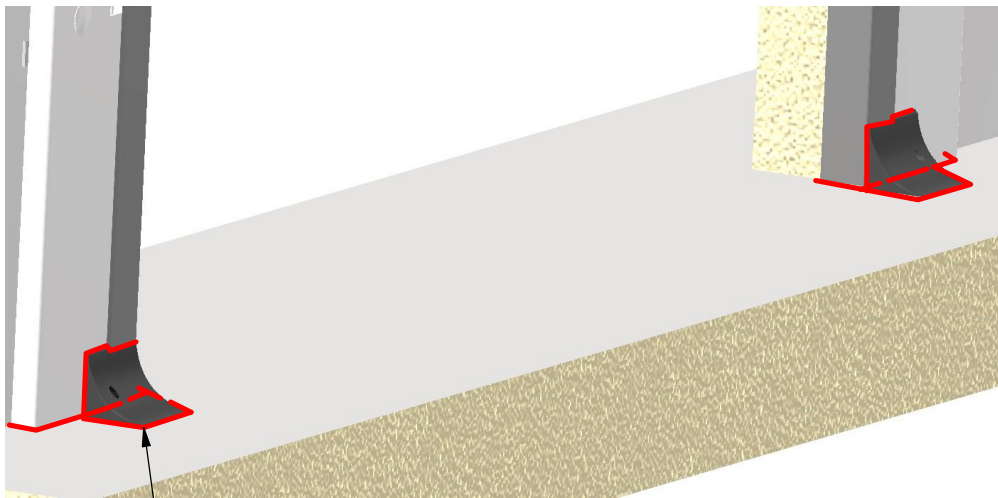

- Caulk the highlighted areas:
- All around the Thermal Break trim & wall frame at the floor
  - All Around the Radius Piece
  - Smooth with finger for a better seal (No air pockets)

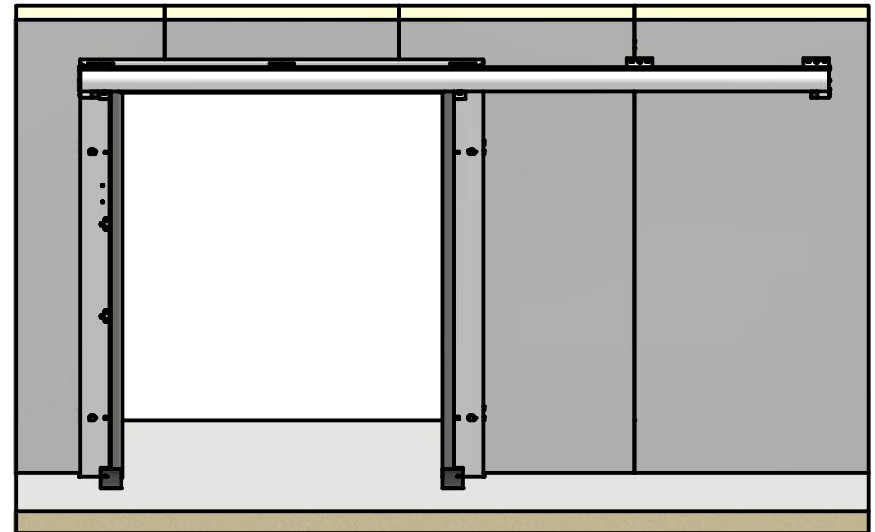

# WHEEL BRACKET ASSEMBLY

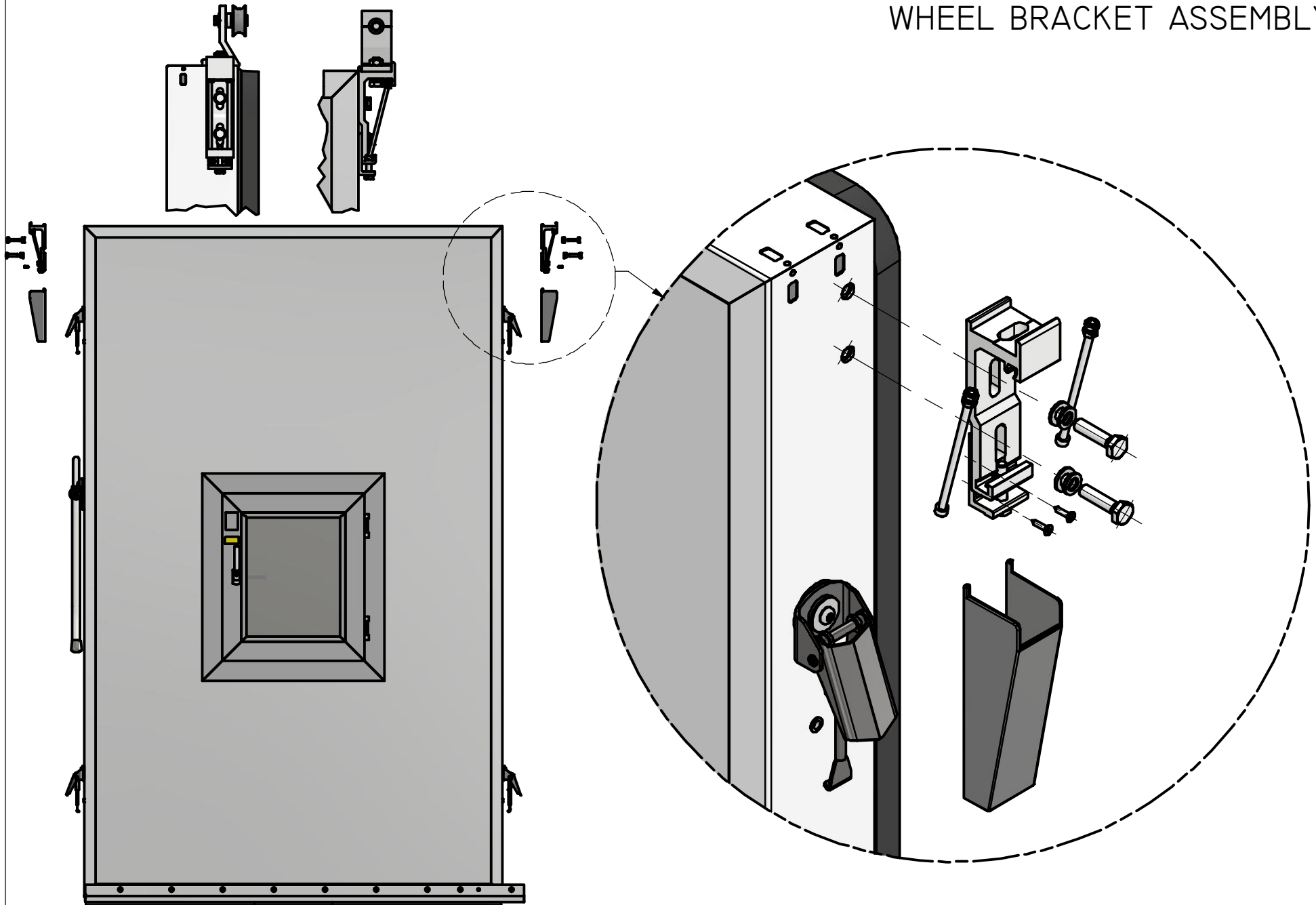

Note:

Assemble the wheel bracket assembly to the door **before** standing it upright

Otherwise you're going to be up and down the ladder/lift, picking washers up off the ground when you drop them



G R O W   C O N T R O L L E D ,   L L C  
100 APPLEWOOD DRIVE SPARTA MICHIGAN · SODUS NEW YORK · UNION GAP WASHINGTON · PADDOCK WOOD UK  
T 616.256.0420 · F 616.887.1128 · INFO@GROWCONTROLLED.COM · GROWCONTROLLED.COM



# DOOR HANDLE ASSEMBLY & CLIP

## **DOOR HANDLE ASSEMBLY STEPS**

1. Assemble the plates to the door, as shown
2. Slide the bushing into the slots
3. Insert the handle sub-assembly
4. Insert through the hole, as shown
5. Screw in to complete the assembly

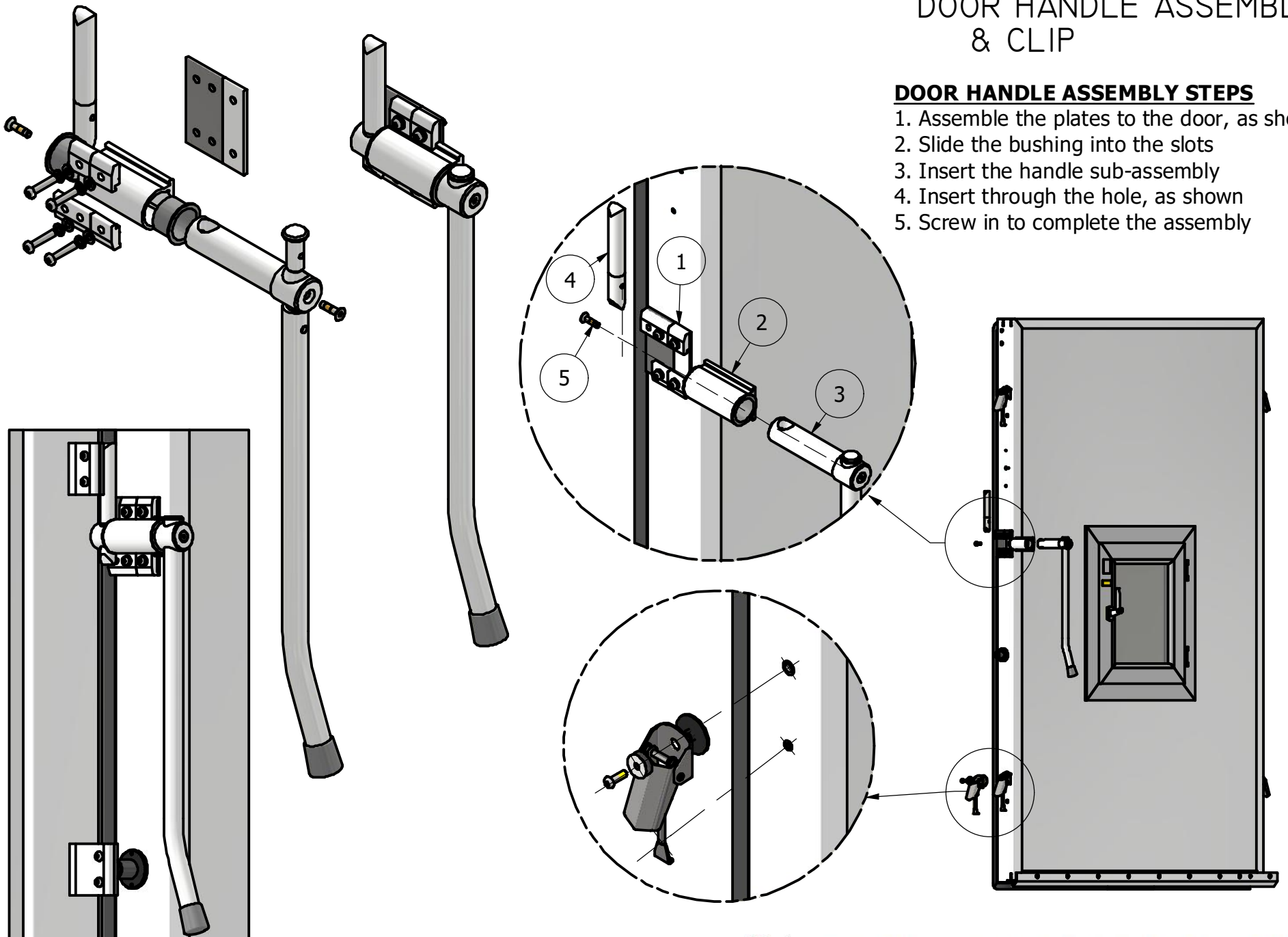



# BOTTOM GUIDE RAIL

**\*Before Assembling, Grind\*** the sharp edges, buff them out to be rounded edges, otherwise they will catch the Bottom Gliders when sliding the door.

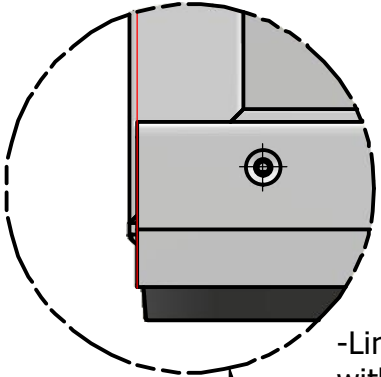
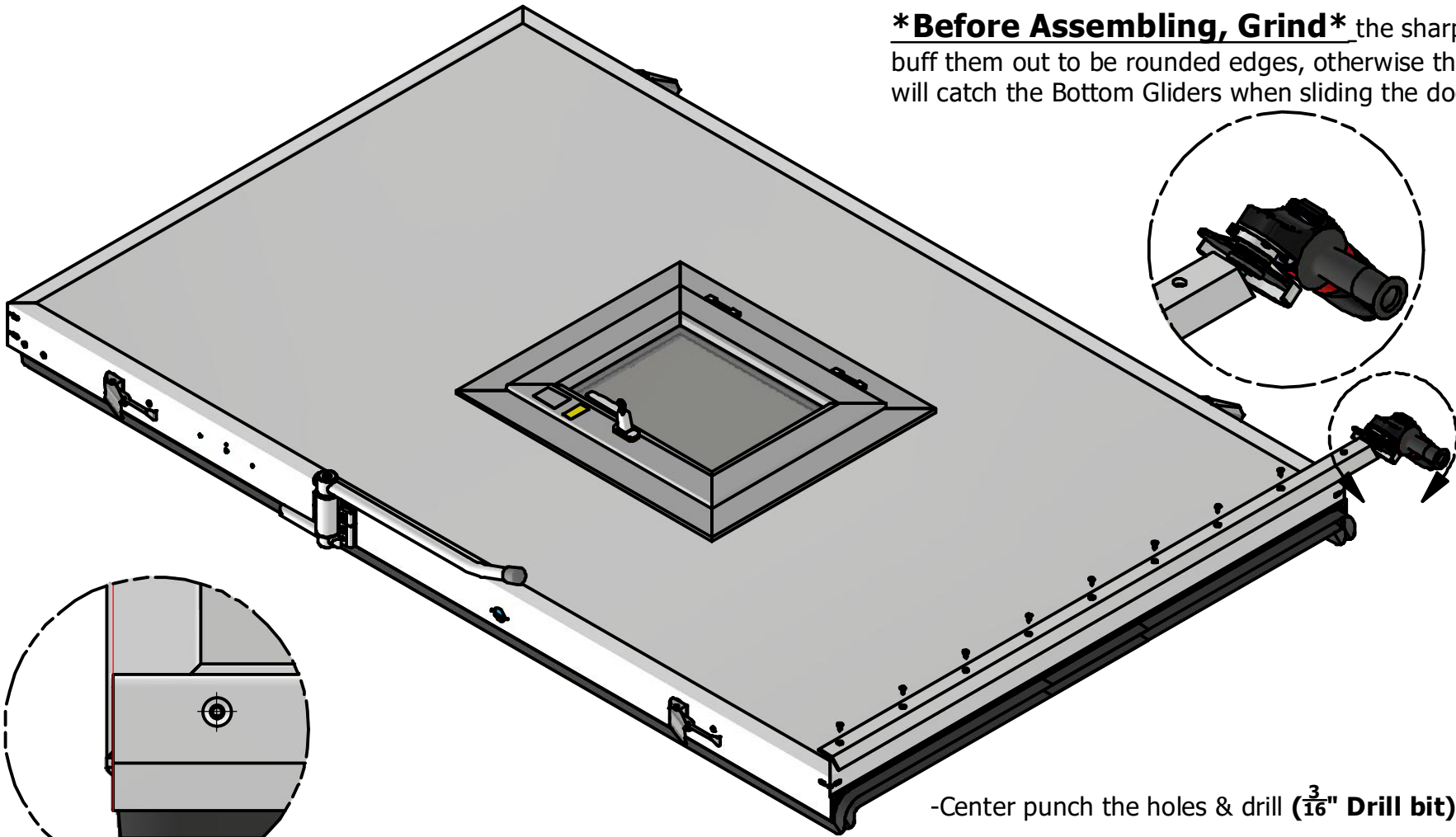

-Line up the edge of the bottom guide rail with the edge of the radius of the door side profile

-Center punch the holes & drill ( $\frac{3}{16}$ " Drill bit)

-Grease the ends of the screws before screwing them in

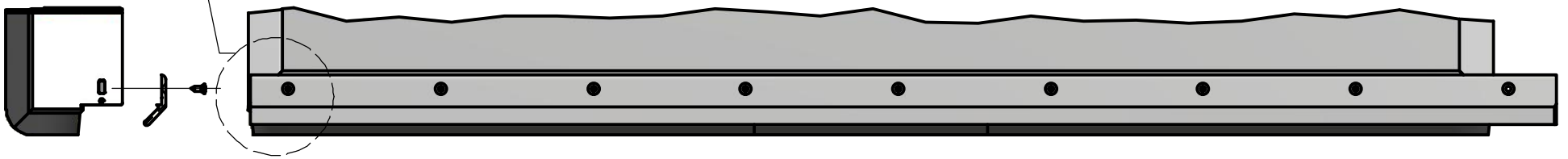

Example shown: Right Slide Growtight Door

# INSIDE OPENER STYLES

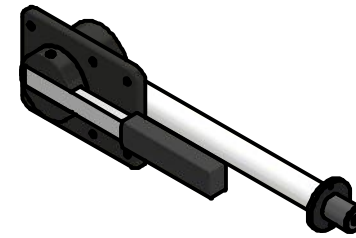
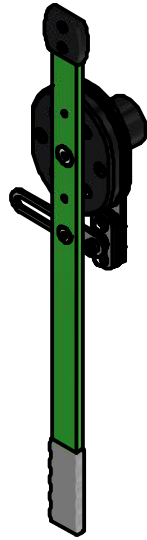

Sliding Growtight Doors have (2) options for inside opening mechanisms:

- Interior Release Lever (Green handle)
- Pull Lever Opener (Plunger style)

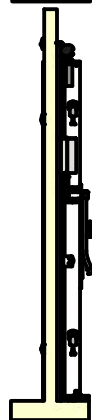
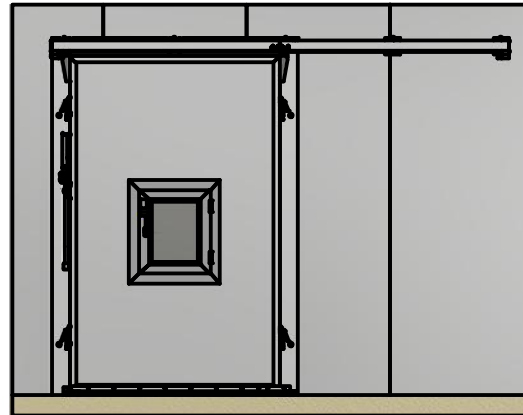
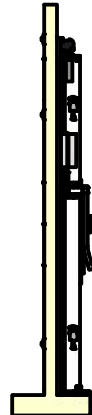
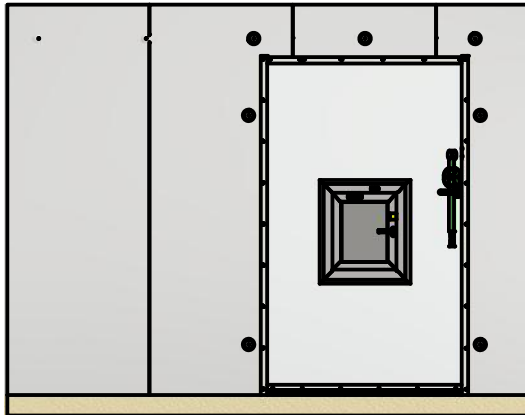

# INSTALLING THE INTERIOR RELEASE LEVER

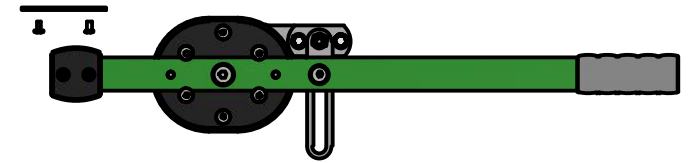
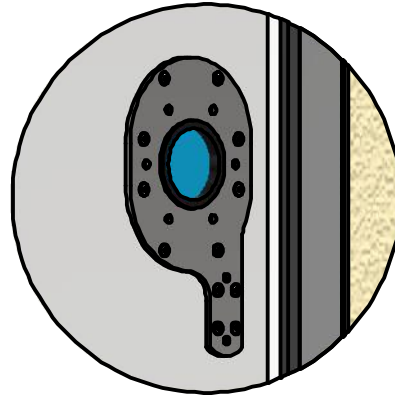
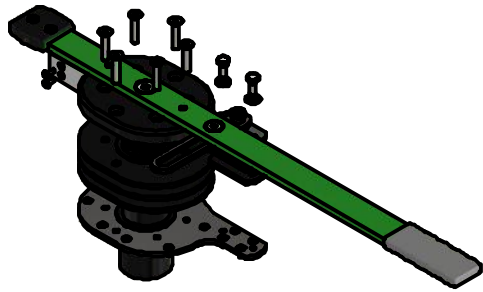

Apply grease to the screws before inserting

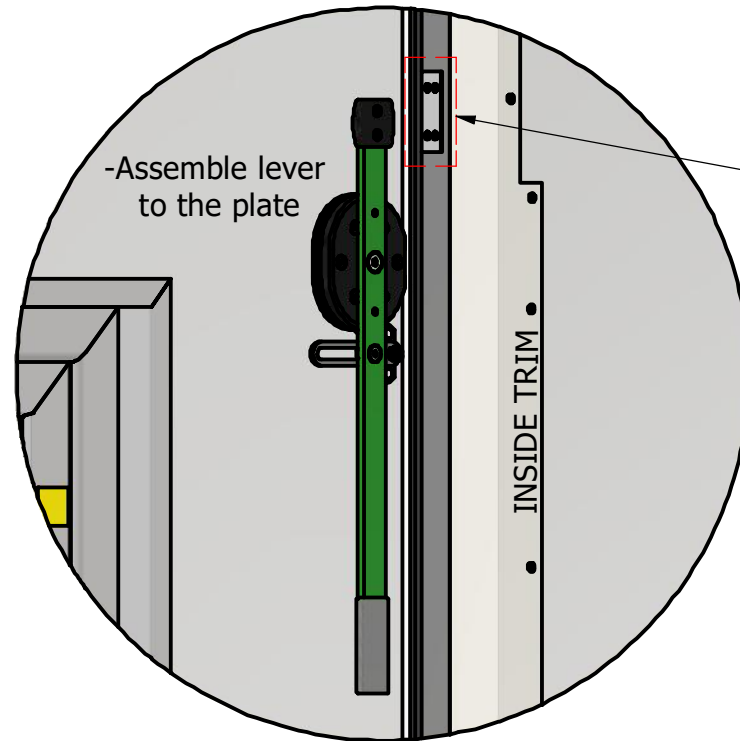
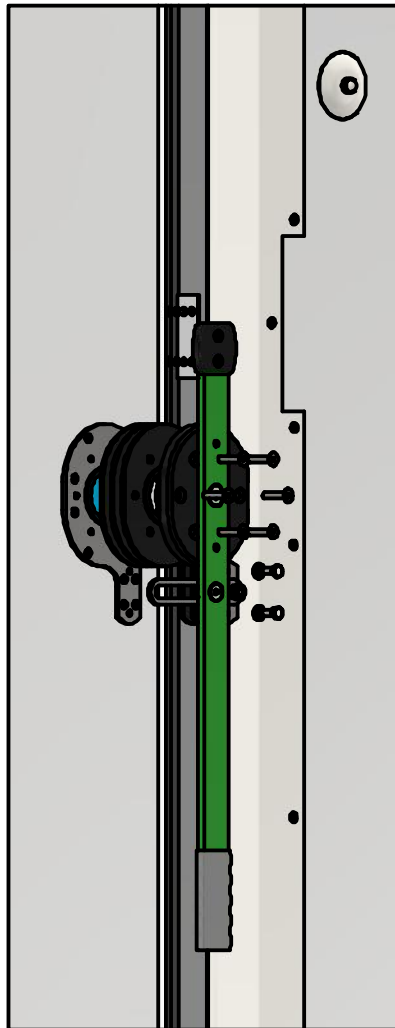

-Assemble lever to the plate

**\*DO THIS STEP AFTER INSTALLING THE INSIDE TRIM\***

- Mark placement of push plate on thermal break
- Drill (4) holes ( $\frac{3}{16}$ "
- Caulk (4) Holes
- Rivet into place



# INSTALLING THE WALL FRAME PUSH PLATES

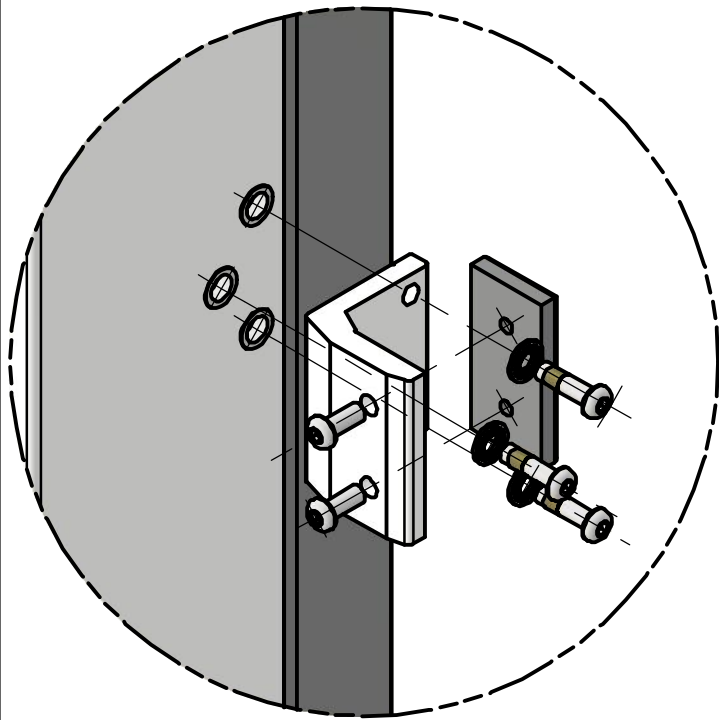

-If the **Interior Release Lever** is being installed, there will be **(1) push plate** to be installed to the wall frame

-If the **Pull Lever (Plunger Style)** is being installed, there will be **(2) push plates**. The **larger push plate** will be installed on the **lower end**

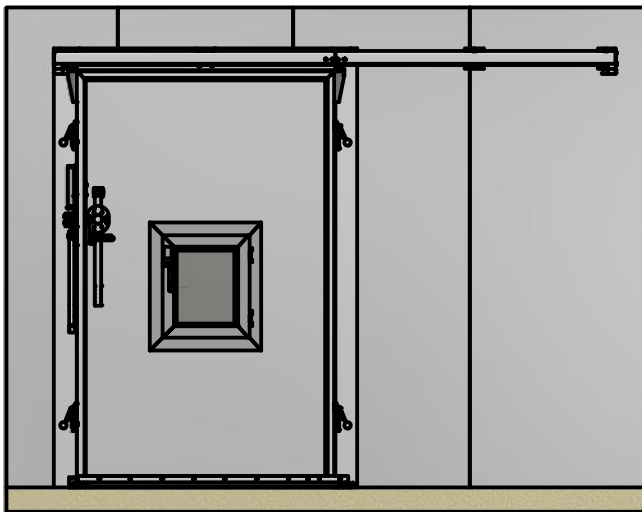
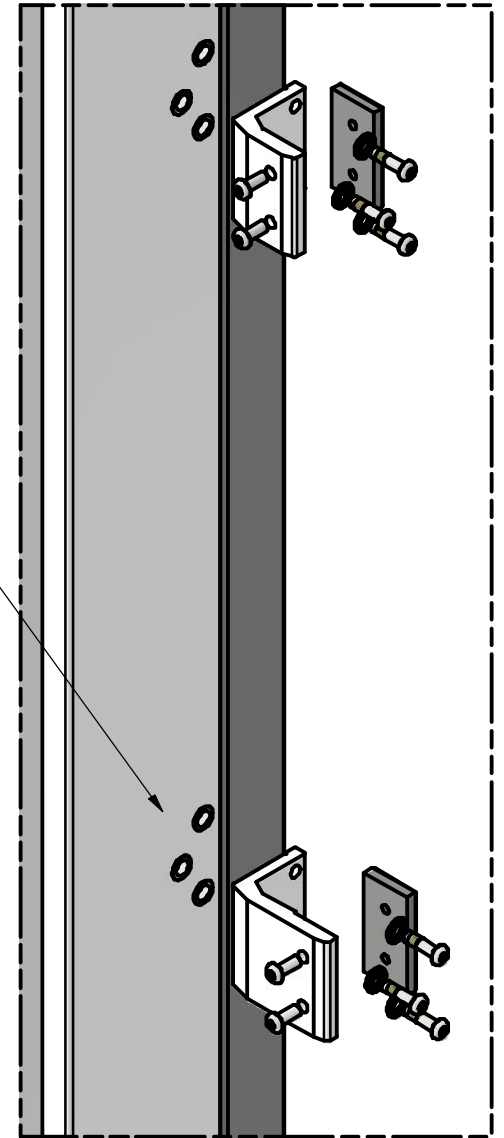

**Interior Release Lever**

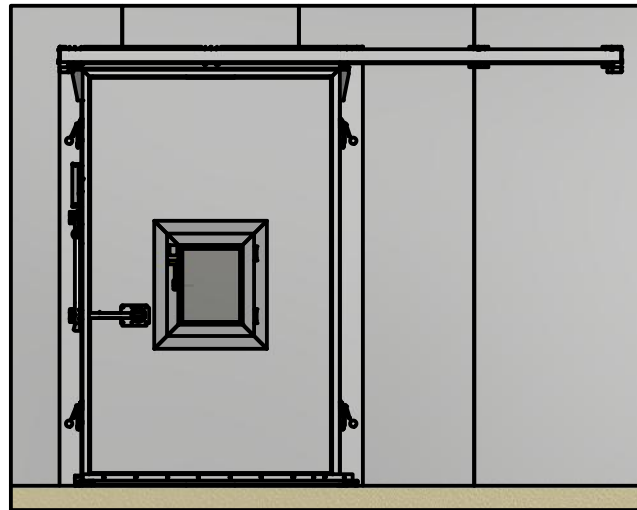

**Pull Lever (Plunger Style)**



## MOUNTING THE DOOR

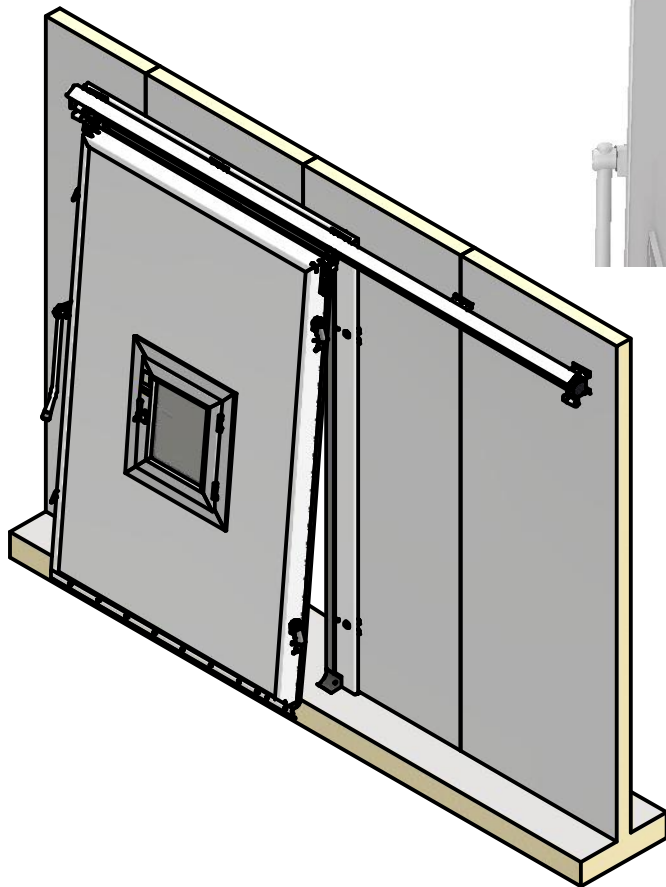

-Loosen the two hex bolts shown to allow for vertical adjustment

-Fasten the hex bolt + washers through the door wheel bracket assembly to the wheel bracket assembly on the track

-Make adjustments to raise/lower the door with the lift bolt

-Tighten the two hex bolts on the door profile



G R O W   C O N T R O L L E D ,   L L C  
100 APPLEWOOD DRIVE SPARTA MICHIGAN - SODUS NEW YORK - UNION GAP WASHINGTON - PADDOCK WOOD UK  
T 616.256.0420 - F 616.887.1128 - INFO@GROWCONTROLLED.COM - GROWCONTROLLED.COM

# MOUNTING THE DOOR

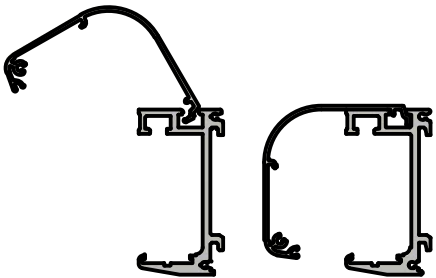

-Hook the Finishing Cover back into the track and press down

-Make adjustments as needed to ensure a proper seal between the door/floor & door/wall frame

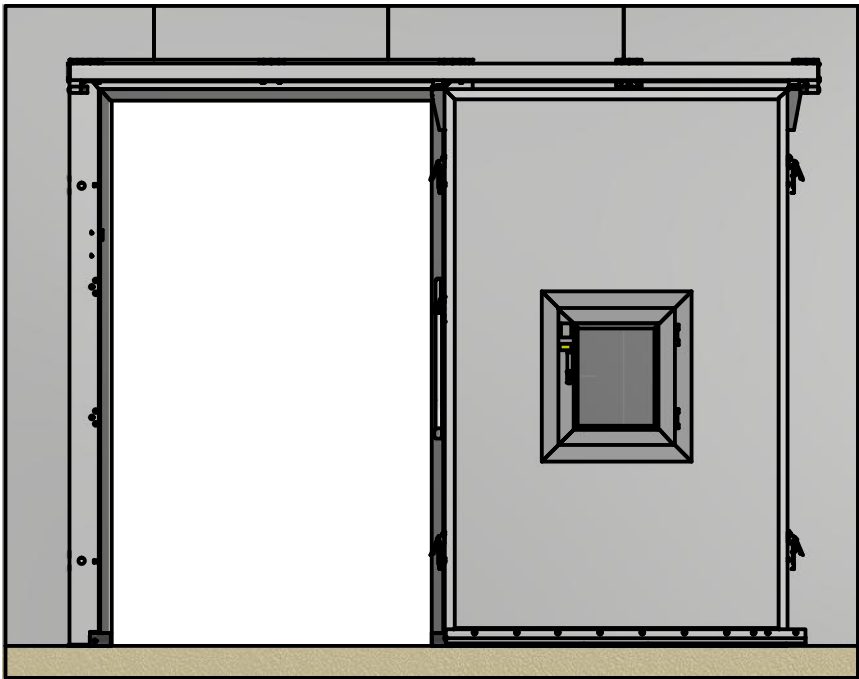
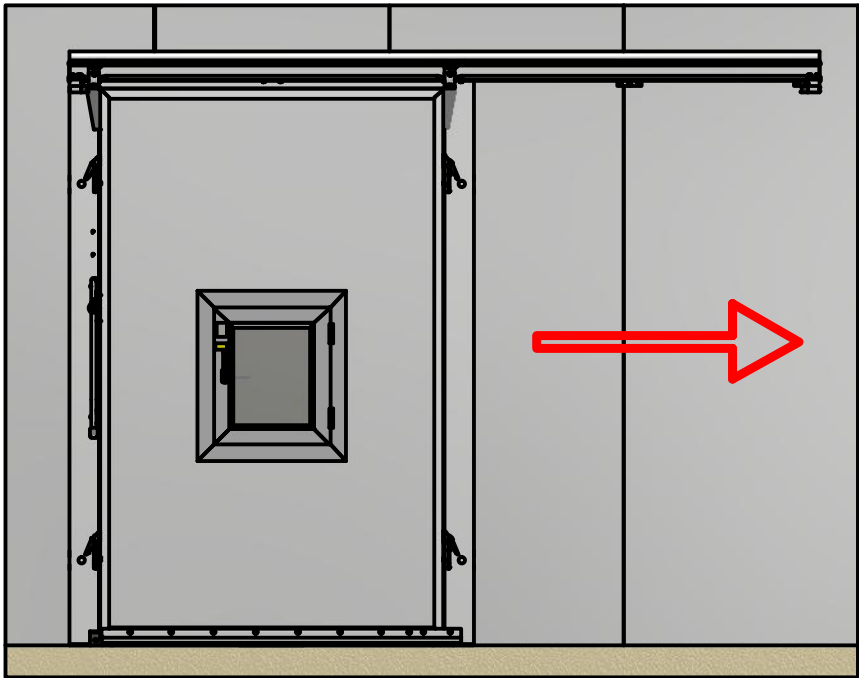



# INSTALLING THE MAGLOCK

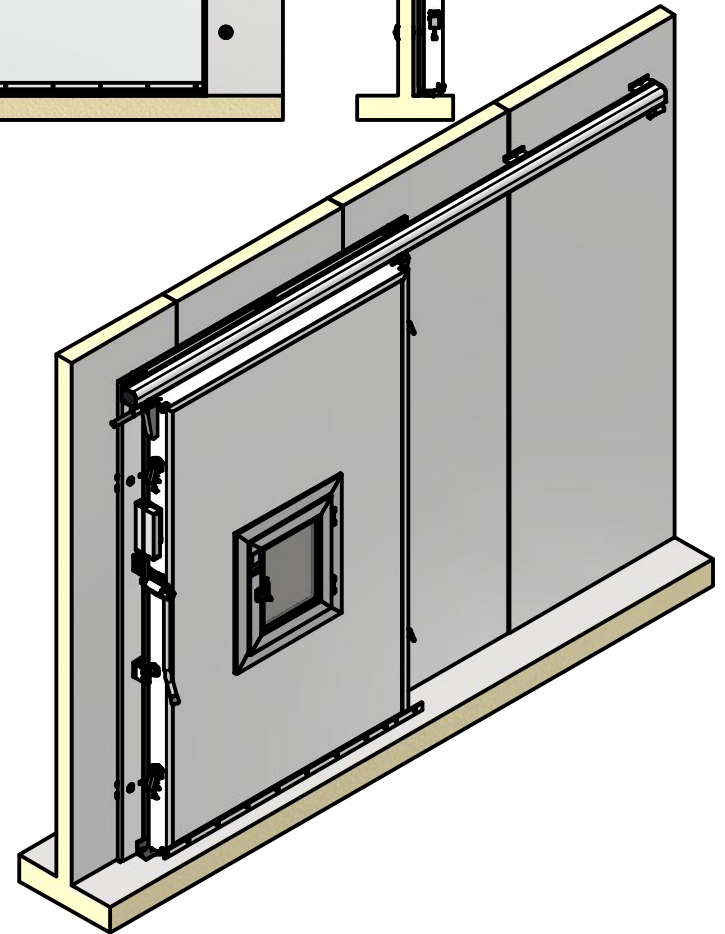
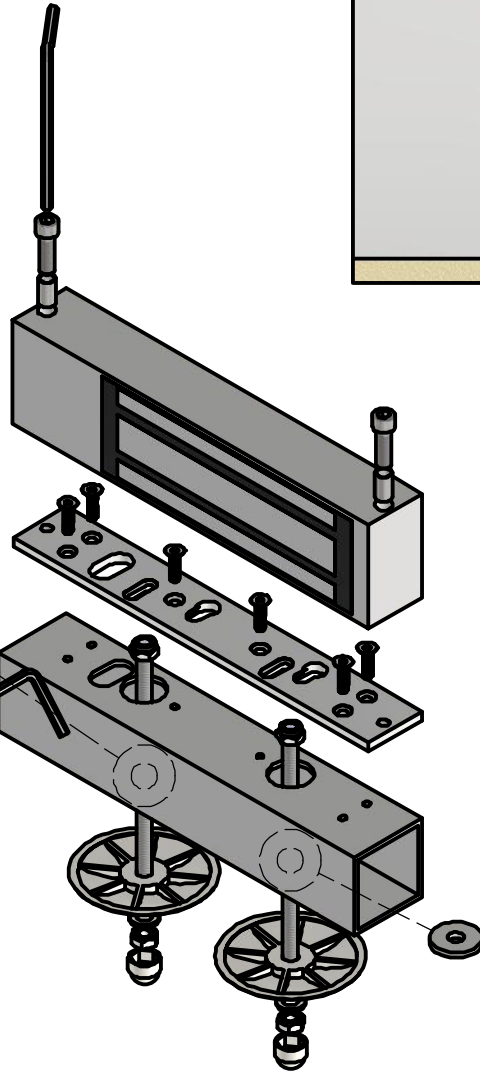
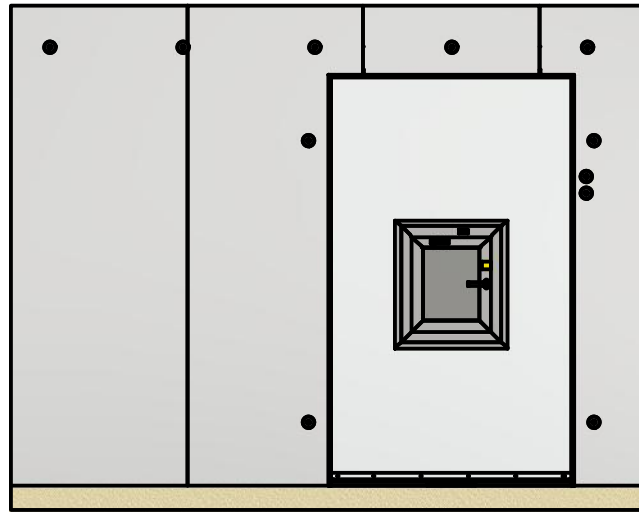
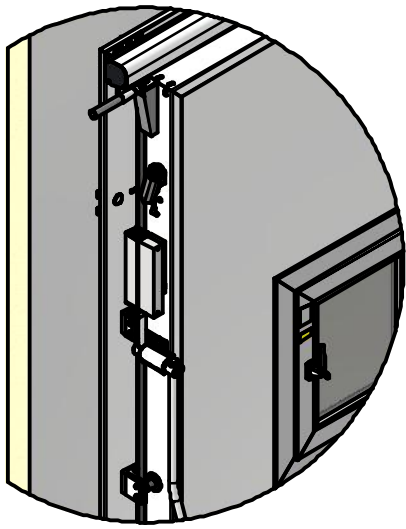

# INSTALLING THE MAGLOCK

-Secure the Maglock Block to the door with supplied Flathead Screw

-With the door in the closed position, hold the Maglock Assembly up to the wall frame and mark the positioning

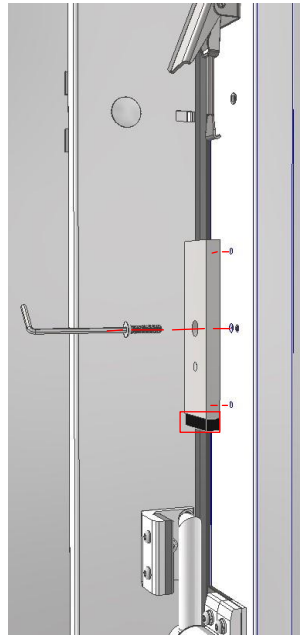
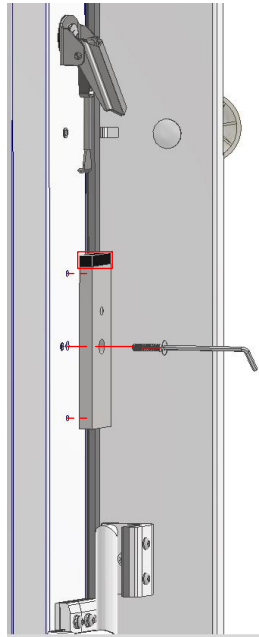
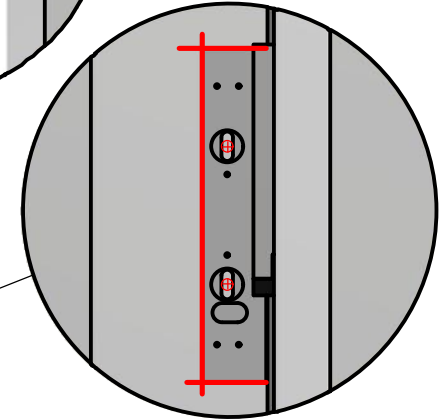
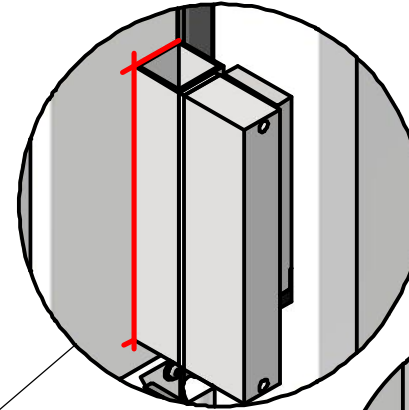
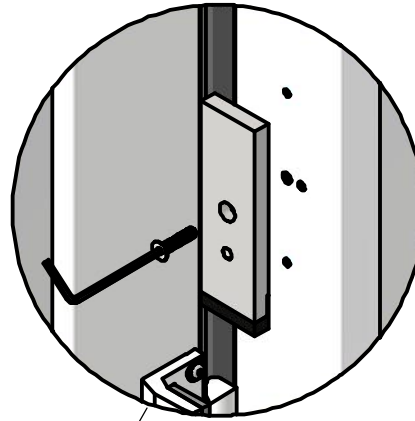

Left Slide  
-Black end points up

Right Slide  
-Black end points down

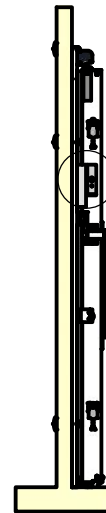
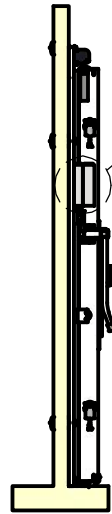
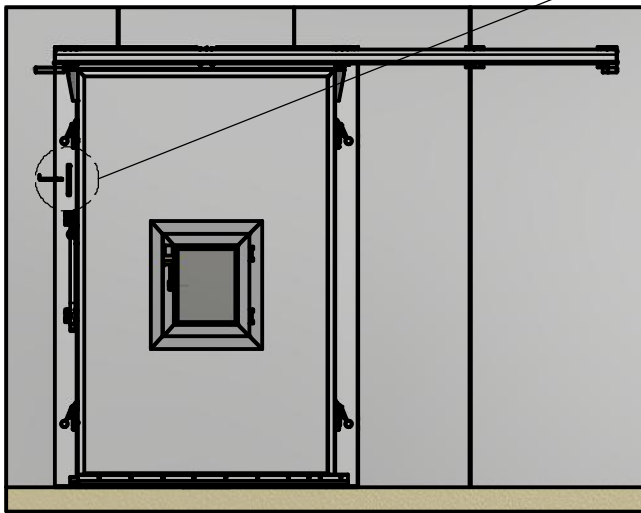

-Disassemble the Maglock & hold the aluminum tube in position

-Mark the location of the drill points on the wall frame



# INSTALLING THE MAGLOCK

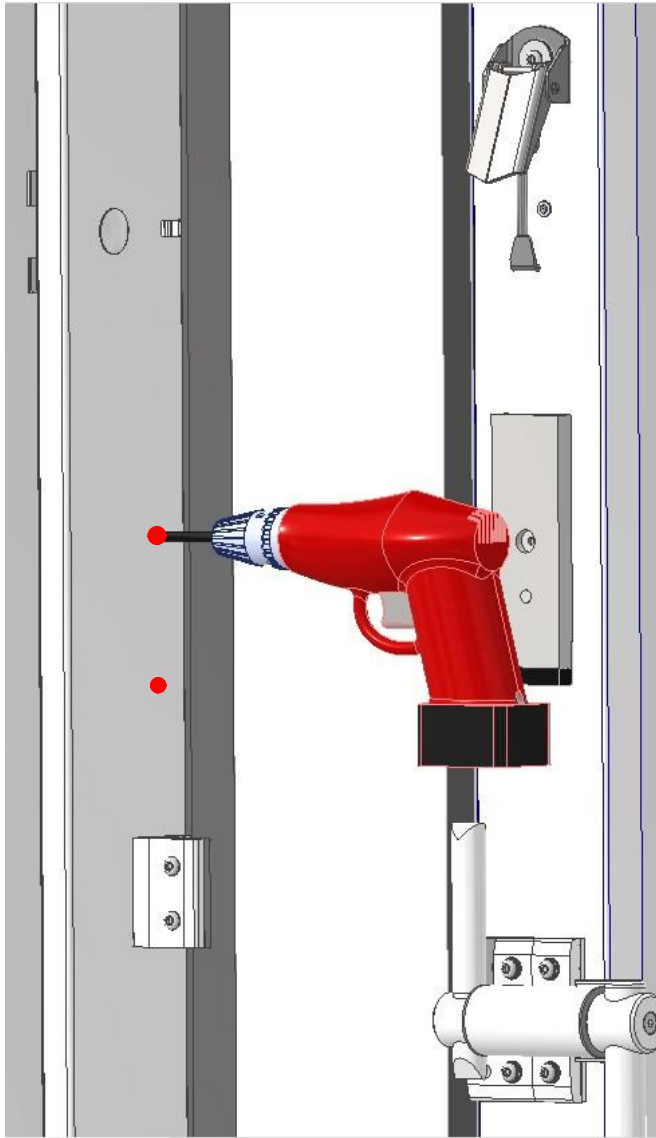

-Drill through the wall frame  
& the wall  
-Use a  $\frac{5}{16}$ " Extended Drillbit

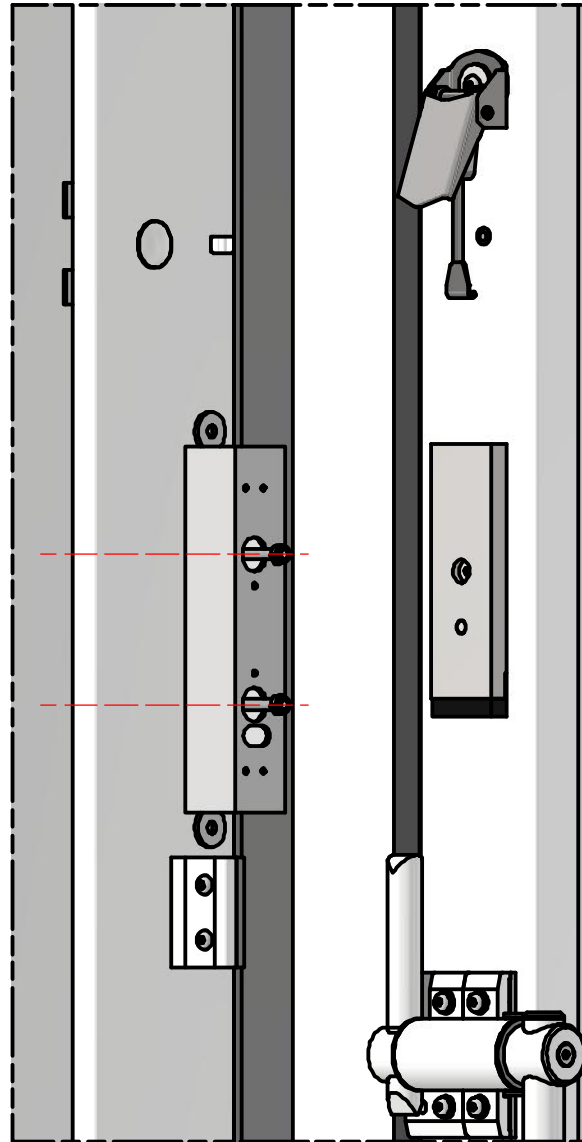

-Insert threaded rod  
with hex nut & heavy  
fender washer

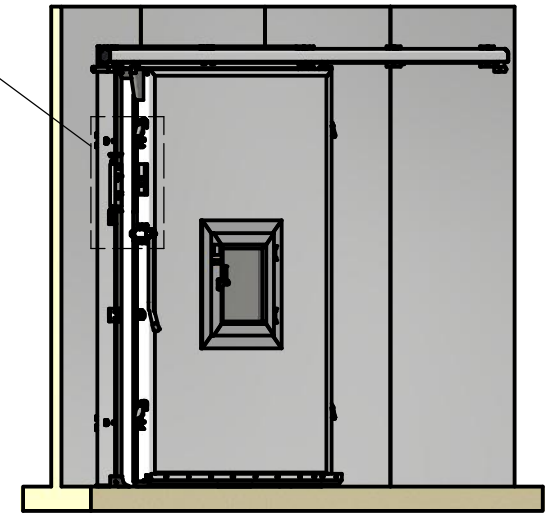
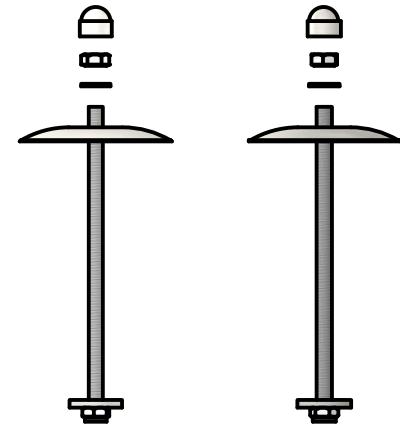

# INSTALLING THE MAGLOCK

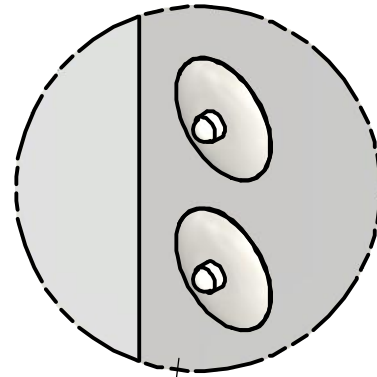

## Threaded Rod Assembly Process:

- Caulk Hole
- Assemble Disc/Washer/Nut
- Tighten
- Let Dry
- Grind Excess Rod
- Cap with Acorn Nut

- Assemble the Maglock as shown:  
-Screw the mounting plate to  
the square tube with screws provided:

- (7x) 10-32 x  $\frac{3}{4}$ " Flathead screws
- Secure the Maglock block to the mounting place with:
  - (2) Shoulder Sleeves
  - (2)  $\frac{5}{16}$ "-18 x 1" Socket Head cap screws

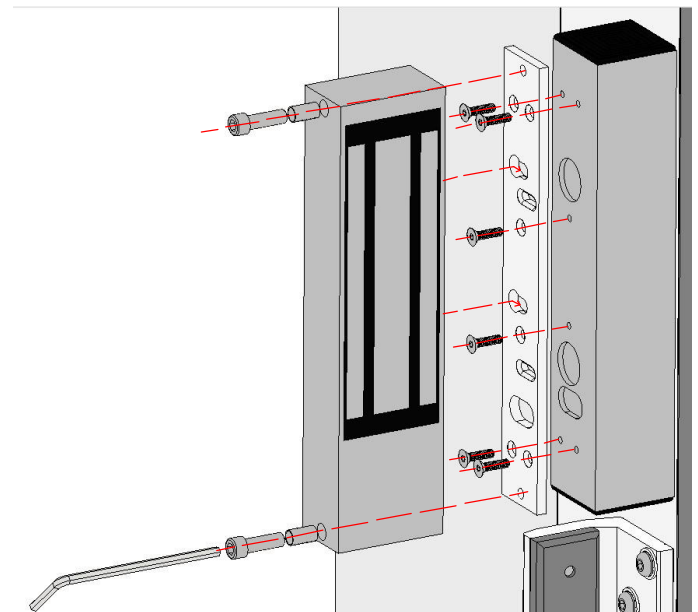
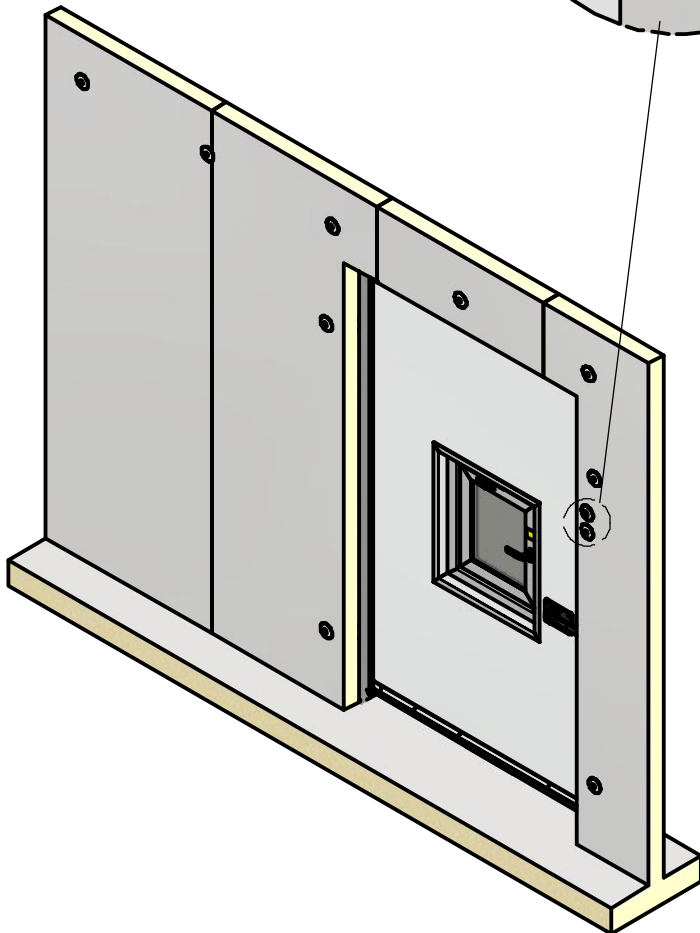

X=Positional Tolerance

-Area between Centerline of Bottom Glider to the outermost bolt hole being lined up with the end of the bottom rail

**But no further in either direction**

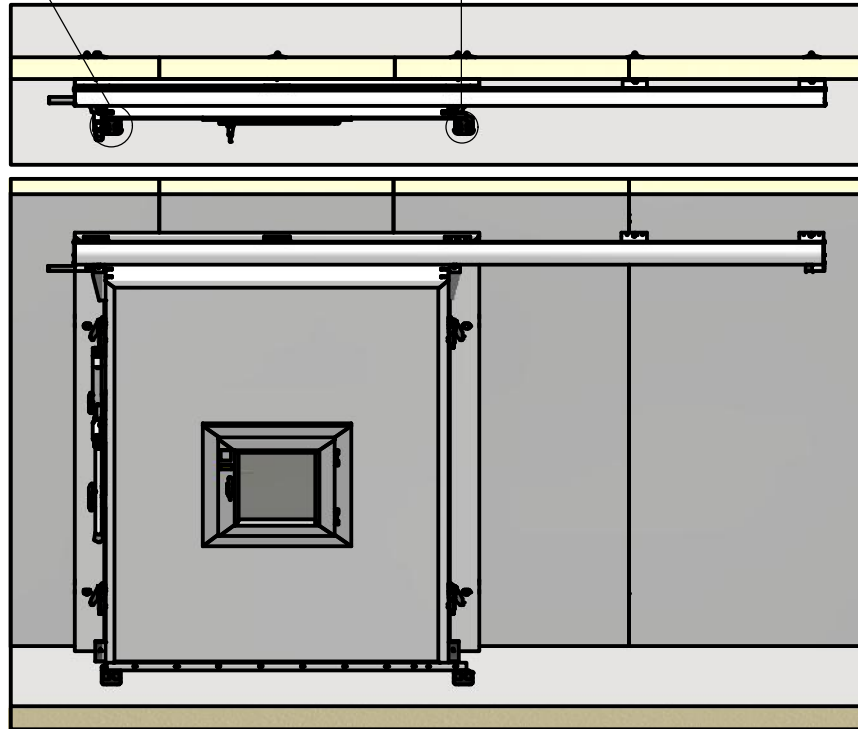
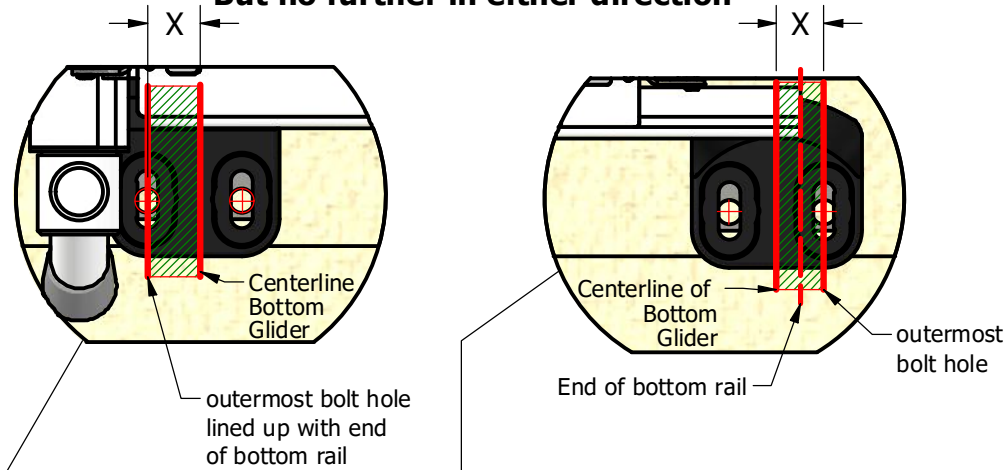

## BOTTOM GLIDERS

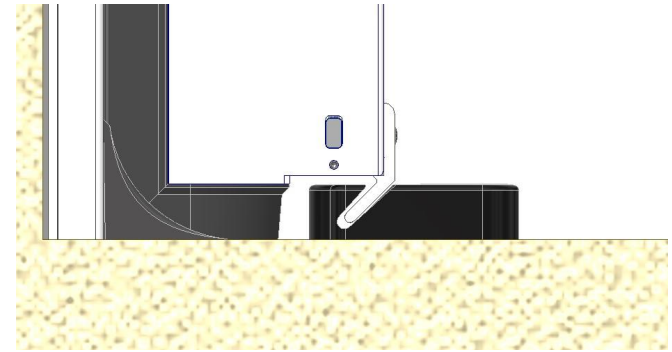

**DOOR CLOSED SIDE**

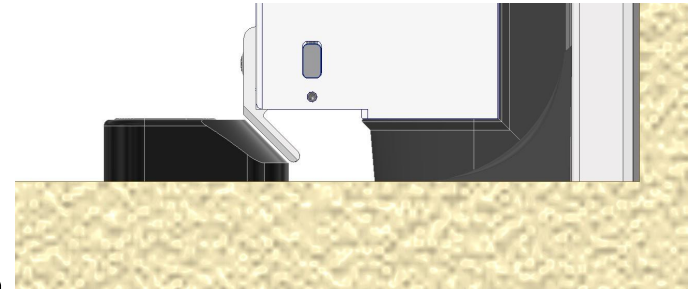

**DOOR OPENED SIDE**

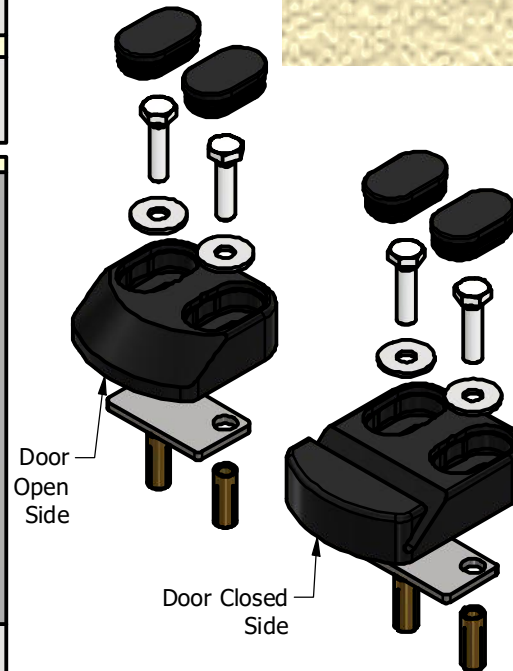

- Position the **Bottom Gliders** as shown
- Mark the holes & Drill
- \*Use a hammer drill &  $\frac{7}{16}$ " **Drill Bit**
- Fasten the gliders to the floor
- Test the sliding motion of the door multiple times
- Make adjustments as needed



# INSIDE TRIM

The trim slips inside the Thermal Break



**\*Before installing the inside trim\***

-Heat up & bend the tip of applicator to fill this area with 798

**\*DO THIS FOR THE LENGTH OF ALL (3) THERMAL BREAKS\***

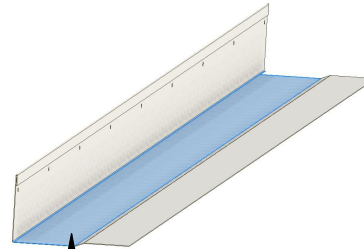

Sprayfoam the highlighted area to fill the gap between the wall and the trim

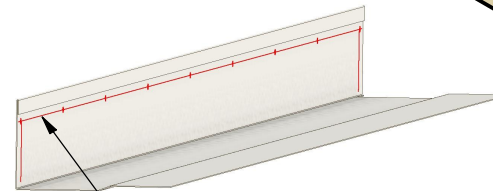

-Run a bead of NP1 down the screwline & around the holes

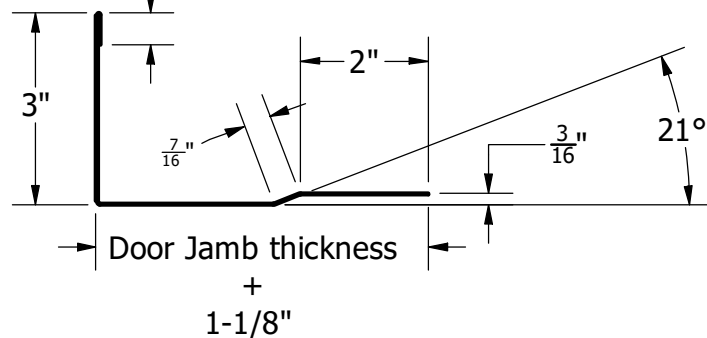
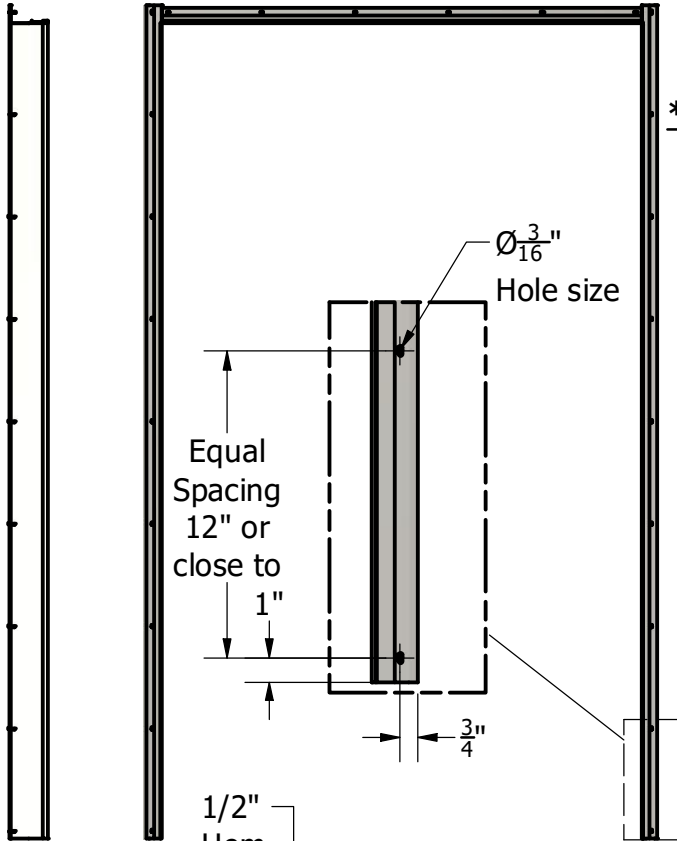



# INSIDE TRIM

-Seal all around the perimeter of the trim with 798 or NP150, Silicone

-The top corners of the side trim are cut to be able to form the corners

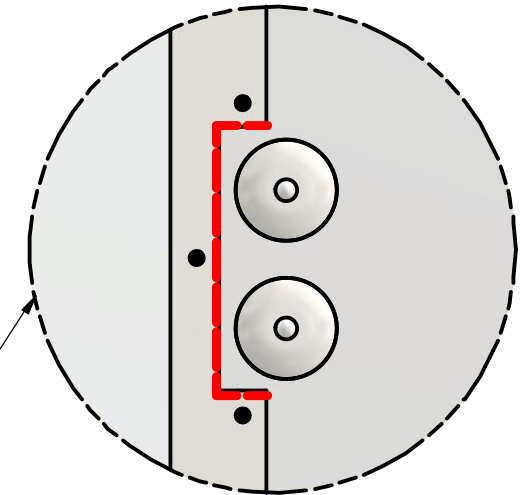
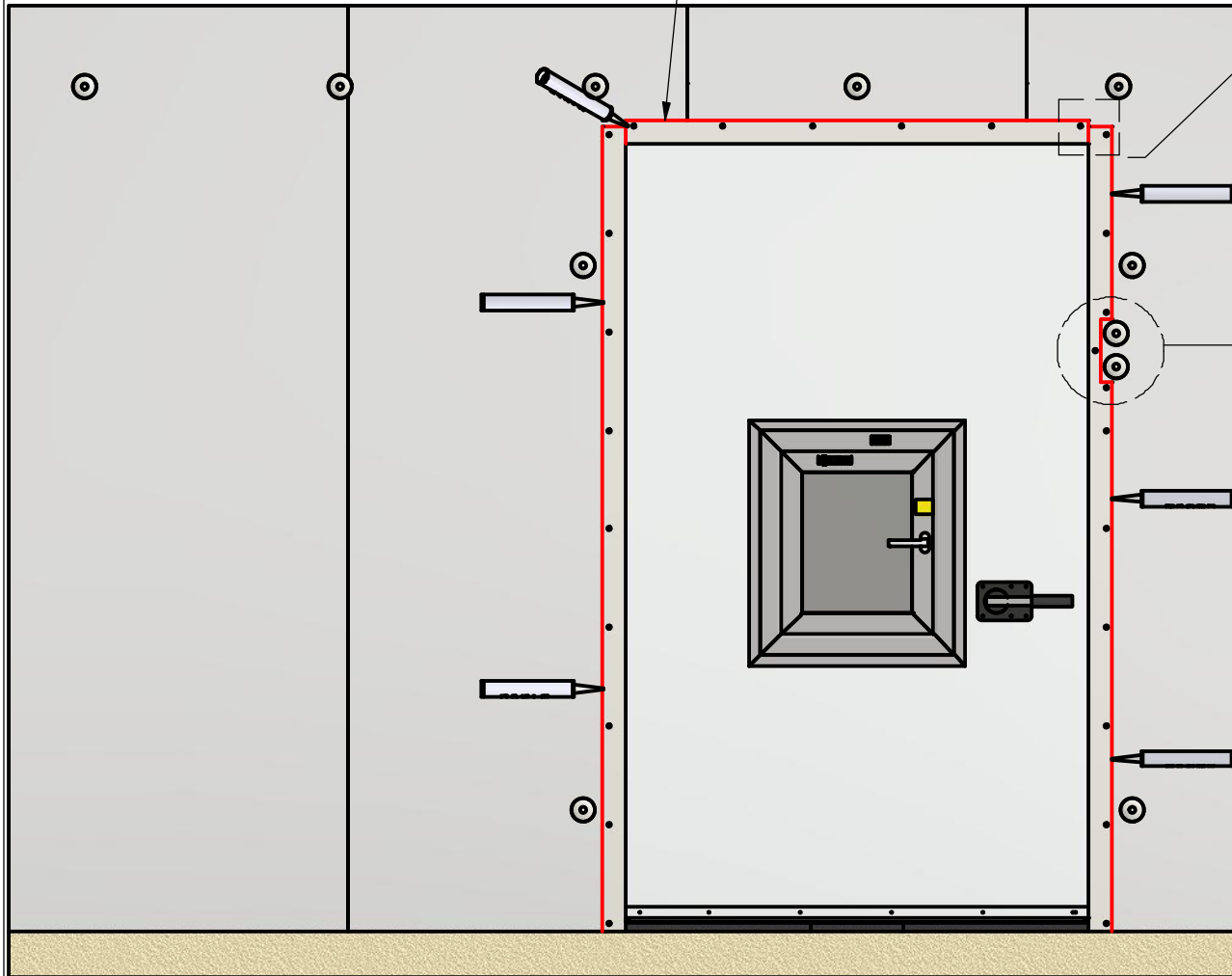
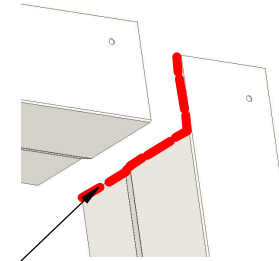

-If the Maglock is being installed, this section trim may need to be cut away to make room for the threaded rod assemblies shown

# CAULK THE WALL FRAME

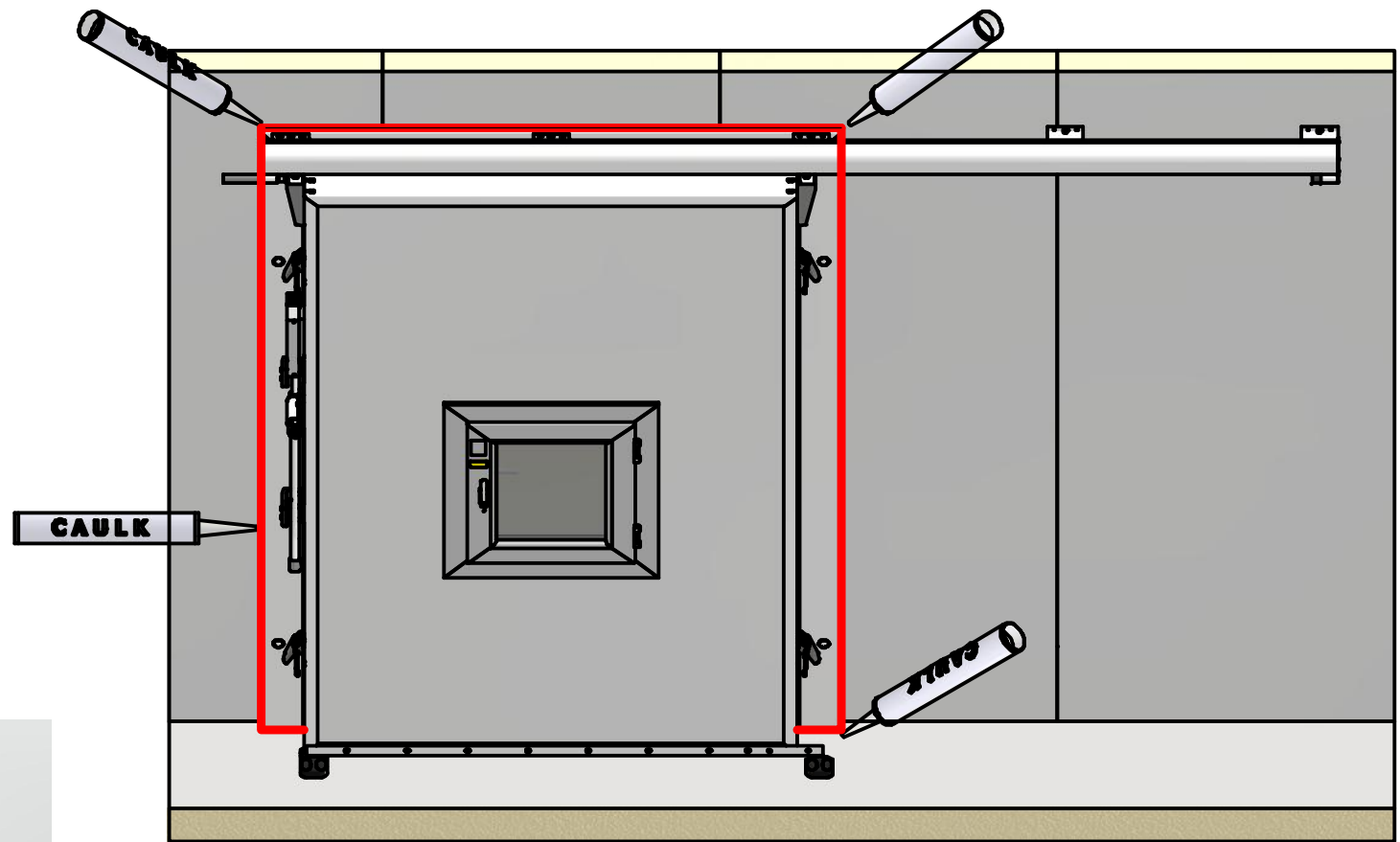

-Caulk the perimeter of the wall frame  
(302 White)

-Caulk the gap between the Thermal Break  
& the Inside Frame

